

Dry All

Full Range of HVAC&R Line Products





EARTH ❄ SYSTEM ❄ YOU

HISTORY

More than three decade with

Dry All
Full Range of HVAC&R Line Products

- 1990** : Started commercial production of Automobile Receiver Drier, for the first time in India.
- 1992** : Commercial production of Filter Drier with one model DM 032 (DM 50).
- 1995** : Introduced complete range of DM Series for sale in India.
- 1999** : Development & Export of Heavy Duty Automobile Receiver Drier for USA market.
- 2000** : Developed Aluminum Receiver Drier for Automobile Air-conditioning.
- 2001** : Introduced DC Range of Filter Driers.
- 2002** : Introduced DG Range of Filter Driers. Exported complete range of Filter Driers.
- 2003** : Developed & Exported Accumulators for an OEM in Middle-East. Supplied Filter Driers & Accumulators to leading OEM's in India.
- 2004** : Started export of complete range of Filter Driers and Accumulators to one of the leading OEM in Middle-East. Doubled the size and capacity of the manufacturing unit. Developed Liquid Refrigerant Receivers.
- 2005** : Was one of the most eventful year with Introduction of 5 new products.
Approved & registered for ISO 9001:2000 Certification from Underwriters Laboratories Inc.
- 2006** : Exports to 15 Countries worldwide and sales to major OEMs and HVAC dealer's in India.
- 2007** : Introduction of Oil Separator, Fusible Plug & Rotolock Valve.
- 2008** : New state of the art green field manufacturing facility near Mumbai.
- 2009** : Up - Graded to ISO 9001:2008
Up-gradation of product to be R-410A READY & RoHS compliant.
- 2010** : File No. SA33181  for filter drier.
Introduced three new product (Sight Glass/Ball Valve/Coaxial HE).
- 2011** : Introduced Bi Flow Filter Drier.
- 2012** : Introduced Suction Line Heat Exchanger Accumulator / VRF Accumulator & Patented Oil Separator.
- 2013** : Introduced Liquid Refrigerant Receiver Deep Draw Type .
- 2014** : Launched new models of Liquid Line Filter Drier & Suction Line Filter designed specifically for Transport Refrigeration.
- 2015** : Launched special Design & Larger diameter vessels designed for OEM Customers.
- 2017** : File No. SA44851  for Oil Separator.
- 2018** : File No. SA45127  for Suction Line Accumulator.
- 2019** : Introduced Filter Driers with Inbuilt Fluorescent Dye.
Introduced Widest Range of Heat Exchangers:
Braze Plate Heat Exchangers, Swimming Pool Heat Exchangers, Economiser,
Shell & Tube Heat Exchangers
Introduced Vibration Absorber

INDEX

FILTER DRIERS

Liquid Line Filter Drier [DMH Series]	1-4
Liquid Line Filter Drier with Sight Glass [DMHSG Series]	5-7
Liquid Line Filter Drier [DCH Series]	8-11
Liquid Line Filter Drier with Sight Glass [DCHSG Series]	12-14
Suction Line Filter Drier [DCHSF Series]	15-17
Bi-Flow Filter Drier [DCHBF Series]	18-19
Suction Line Filter [DSF Series]	20
Filter Drier for Bus AC & Truck Refrigeration	21
Filter Drier With Tracer Wafer	22

FILTER DRIER CORE & SHELL

Replaceable Core Shell [DRC Series]	23
Suction Line Filter	24
Replaceable Filter Drier Core	24

VESSELS

Suction Line Accumulator & Suction Line Heat Exchanger Accumulator	25-27
Liquid Refrigerant Receiver Horizontal Type	28
Liquid Refrigerant Receiver Vertical Type	29
Liquid Refrigerant Receiver Deep Draw Type	30
Oil Separator	31

HEAT EXCHANGERS

Coaxial Heat Exchanger	32
Brazed Plate Heat Exchanger	33
Titanium Heat Exchanger	34
Economiser	35
Shell And Tube Heat Exchanger	36

VALVE & ACCESSORIES

Vibration Absorber	37
Rotolock Valve	38
Snub Adaptors	39-40
Gasket	40
Moisture & Liquid Indicator / Sight Glass	41
Ball Valve	42
Fusible Plug	42

LIQUID LINE FILTER DRIER DMH SERIES (BEAD TYPE)



IMAGES



File No. SA33181



03-SERIES



05-SERIES



08-SERIES



Internal View

16-SERIES



30-SERIES



41-SERIES



Filter Drier with ODF connection

LIQUID LINE FILTER DRIER DMH SERIES (BEAD TYPE)

DRAWINGS



DIMENSIONAL DATA		
DRAWING -1	DRAWING -2	DRAWING -3
DRAWING -4	DRAWING -5	DRAWING -6
DRAWING -7	DRAWING -8	DRAWING -9
DRAWING -10	DRAWING -11	DRAWING -12

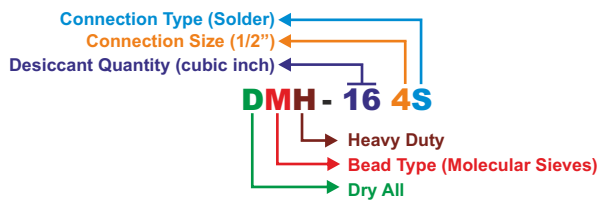

LIQUID LINE FILTER DRIER DMH SERIES (BEAD TYPE)

MODELS AVAILABLE



Sr No.	Model	Connection Type	Outer Dia ØA		Body Length B		Stopper To Stopper Length C		Overall Length D		Refer Drawing No.				
			mm	Inch	mm	Inch	mm	Inch	mm	Inch					
1	DMH-032F	1/4" SAE	Ø 42	Ø 1.6	67	2.64	--	--	113	4.45	DRAWING - 1				
2	DMH-032M-F*F	1/4" SAE (F/M)					--	--	102	4.00	DRAWING - 9				
3	DMH-032S	1/4" ODF					97	3.82	117	4.61	DRAWING - 2				
4	DMHSV-032F	1/4" SAE					--	--	113	4.45	DRAWING - 8				
5	DMHSV-032S	1/4" ODF					97	3.82	117	4.61	DRAWING - 7				
6	DMH-033F	3/8" SAE					--	--	121	4.76	DRAWING - 1				
7	DMH-033S	3/8" ODF					97	3.82	117	4.61	DRAWING - 2				
8	DMH-052F	1/4" SAE	Ø 63.5	Ø 2.5	78	3.07	--	--	124	4.88	DRAWING - 3				
9	DMH-052S	1/4" ODF					108	4.25	128	5.04	DRAWING - 4				
10	DMH-053F	3/8" SAE					--	--	132	5.20	DRAWING - 3				
11	DMH-053S	3/8" ODF					108	4.25	128	5.04	DRAWING - 4				
12	DMH-053R	11/16-16 ORFS					--	--	116	4.56	DRAWING - 5				
13	DMH-082F	1/4" SAE					Ø 76.2	Ø 3	99	3.90	--	--	145	5.71	DRAWING - 3
14	DMH-082S	1/4" ODF	129	5.08	149	5.87					DRAWING - 4				
15	DMH-083F	3/8" SAE	--	--	153	6.02					DRAWING - 3				
16	DMH-083S	3/8" ODF	129	5.08	149	5.87					DRAWING - 4				
17	DMH-084F	1/2" SAE	--	--	159	6.26					DRAWING - 3				
18	DMH-084S	1/2" ODF	129	5.08	149	5.87					DRAWING - 4				
19	DMH-163F	3/8" SAE	Ø 76.2	Ø 3	122	4.8					--	--	176	6.93	DRAWING - 3
20	DMH-163S	3/8" ODF									152	5.98	172	6.77	DRAWING - 4
21	DMH-163R	11/16-16 ORFS					--	--	160	6.30	DRAWING - 5				
22	DMH-164F	1/2" SAE					--	--	182	7.17	DRAWING - 3				
23	DMH-164S	1/2" ODF					152	5.98	172	6.77	DRAWING - 4				
24	DMH-164R	13/16-16 ORFS					--	--	162	6.38	DRAWING - 5				
25	DMH-165F	5/8" SAE					--	--	190	7.48	DRAWING - 3				
26	DMH-165S	5/8" ODF					152	5.98	172	6.77	DRAWING - 4				
27	DMH-165R	1"-14 ORFS					--	--	176	6.93	DRAWING - 5				
28	DMHLD-162R	9/16-18 ORFS					Ø 76.2	Ø 3	110	4.33	--	--	148	5.82	DRAWING - 5
29	DMHLD-163F	3/8" SAE	--	--	164	6.45					DRAWING - 3				
30	DMHLD-163R	11/16-16 ORFS	--	--	148	5.82					DRAWING - 5				
31	DMHLD-163RL	11/16-16 ORFS	113	4.44	--	--					177	6.97	DRAWING - 11		
32	DMHLD-164R	13/16-16 ORFS	110	4.33	--	--					150	5.90	DRAWING - 5		
33	DMHLD-164 ORF	1/2" SAE	--	--	176	6.92					DRAWING - 10				
34	DMH-303F	3/8" SAE	Ø 76.2	Ø 3	190	7.48					--	--	244	9.61	DRAWING - 3
35	DMH-303S	3/8" ODF									220	8.66	240	9.45	DRAWING - 4
36	DMH-303R	11/16-16 ORFS									--	--	228	8.98	DRAWING - 5
37	DMHL-303-ORN	3/8" 'O' RING									--	--	244	9.61	DRAWING - 12
38	DMH-304F	1/2" SAE					--	--	250	9.84	DRAWING - 3				
39	DMH-304S	1/2" ODF					220	8.66	240	9.45	DRAWING - 4				
40	DMH-304R	13/16-16 ORFS					--	--	230	9.05	DRAWING - 5				
41	DMH-305F	5/8" SAE					--	--	258	10.16	DRAWING - 3				
42	DMH-305S	5/8" ODF					220	8.66	240	9.45	DRAWING - 4				
43	DMH-305R	1"-14 ORFS					--	--	244	9.61	DRAWING - 5				
44	DMH-306F	3/4" SAE					--	--	264	10.39	DRAWING - 3				
45	DMH-306S	3/4" ODF					220	8.66	240	9.45	DRAWING - 4				
46	DMH-307S*	7/8" ODF					220	8.66	264	10.39	DRAWING - 6				
47	DMH-309S*	1-1/8" ODF					220	8.66	274	10.79	DRAWING - 6				
48	DMH-412 ORN	1/4" 'O' RING	253.6	9.98	--	--	288	11.33	DRAWING - 12						
49	DMH-413F	3/8" SAE	Ø 88.9	Ø 3.5	198	7.80	--	--	258	10.15	DRAWING - 3				
50	DMH-413S	3/8" ODF					228	8.98	248	9.76	DRAWING - 4				
51	DMH-414F	1/2" SAE					--	--	258	10.16	DRAWING - 3				
52	DMH-414S	1/2" ODF					228	8.98	248	9.76	DRAWING - 4				
53	DMH-415F	5/8" SAE					--	--	266	10.47	DRAWING - 3				
54	DMH-415S	5/8" ODF					228	8.98	248	9.76	DRAWING - 4				
55	DMH-415R	1"-14 ORFS					--	--	252	9.92	DRAWING - 5				
56	DMH-415-4F	5/8" SAE (IN) & 1/2" SAE(OUT)					--	--	262	10.31	DRAWING - 3				
57	DMH-415-4R	1"-14 ORFS (IN) & 13/16-16 ORFS(OUT)					188	7.4	--	--	235	9.25	DRAWING - 5		
58	DMH-416-5R	1"-1/4 ORFS (IN) & 1"-14 ORFS (OUT)					198	7.79	--	--	255	10.03	DRAWING - 5		
59	DMH-417S*	7/8" ODF	228	8.98	272	10.71			DRAWING - 6						
60	DMH-419S*	1-1/8" ODF	228	8.98	282	11.10			DRAWING - 6						
61	DMH-757S*	7/8" ODF	311	12.24	341	13.42			385	15.16	DRAWING - 6				
62	DMH-759S*	1-1/8" ODF	341	13.42	395	15.55	DRAWING - 6								

Internal Assembly - Bead Type

Maximum Working Pressure - 45 bar (653 psig)

SAE, ORFS & 'O'Ring Type Connection are in Steel, Nickel Plated

ODF Type Connection is in Copper

*Mark Connection Steel Plated

LIQUID LINE FILTER DRIER SELECTION RECOMMENDATIONS DMH

SELECTION RECOMMENDATION



Sr No.	Model	Connections Type	Flow Capacity Ton @ 1psiΔP (for kw multiply Ton by 3.5)				Water Capacity drops of water											
			R-134a	R-22 & R-410A	R-407C	R-404A & R-507	R-134a		R-22		R-407C		R-410A		R-404A & R-507			
							75° F	125° F	75° F	125° F	75° F	125° F	75° F	125° F	75° F	125° F		
1	DMH - 032F	1/4" SAE																
2	DMH - 032M-F*F	1/4" SAE (F/M)	2	2.2	2.1	1.4												
3	DMHSV - 032F	1/4" SAE																
4	DMH - 032S	1/4" ODF																
5	DMHSV - 032S	1/4" ODF	2.7	2.9	2.9	2	41	39	40	35	34	26	22	20	40	39		
6	DMH-033F	3/8" SAE																
7	DMH - 033S	3/8" ODF	3	3.3	3.2	2.2												
8	DMH - 052F	1/4" SAE	2.5	2.4	2.5	1.8												
9	DMH - 052S	1/4" ODF	3.5	3.6	3.5	2.5												
10	DMH - 053F	3/8" SAE	3.5	3.8	3.8	2.5	121	110	116	99	100	80	66	61	123	110		
11	DMH - 053S	3/8" ODF																
12	DMH - 053R	11/16-16 ORN	4.6	4.8	4.8	3.5												
13	DMH - 082F	1/4" SAE	2.4	2.6	2.5	1.9												
14	DMH - 082S	1/4" ODF	3	3.5	3.5	2.5												
15	DMH - 083F	3/8" SAE	4	4.5	4.5	3												
16	DMH - 083S	3/8" ODF	4.5	4.9	4.9	3.5	265	245	250	225	205	165	170	130	275	260		
17	DMH - 084F	1/2" SAE	6.7	7.5	7	5												
18	DMH - 084S	1/2" ODF	7.1	7.7	7.5	5												
19	DMH - 163F	3/8" SAE	4	4.2	4.2	3												
20	DMH - 163S	3/8" ODF	4.5	4.8	4.7	3.2												
21	DMH - 163R	11/16-16 ORFS	3.9	4.2	4.1	2.8												
22	DMH - 164F	1/2" SAE	8.5	9.5	9.2	6.2												
23	DMH - 164S	1/2" ODF	8.5	9.5	9	6.2	384	348	375	320	312	246	212	194	359	348		
24	DMH - 164R	13/16-16ORFS	8.5	9.2	9	6.2												
25	DMH - 165F	5/8" SAE	9.7	10.5	10.3	7												
26	DMH - 165S	5/8" ODF	10.1	10.9	10.7	7.3												
27	DMH - 165R	1" - 14 ORFS	9.8	10.5	10.3	7												
28	DMHLD - 162R	9/16-18 ORFS	4.2	4.5	4.3	3.2												
29	DMHLD - 163F	3/8" SAE	4.2	4.5	4.3	3.2												
30	DMHLD - 163R	11/16-16ORFS					445	410	437	374	367	291	345	238	422	409		
31	DMHLD - 163RL	11/16-16ORFS	4.1	4.5	4.3	3.1												
32	DMHLD - 164R	13/16-16 ORFS																
33	DMHLD - 164 ORF	1/2" SAE (Groove)	9.5	9	8.8	6.1												
34	DMH - 303F	3/8" SAE	4.5	4.8	4.6	3.5												
35	DMH - 303S	3/8" ODF	6.4	6.8	6.7	4.8												
36	DMH -303R	11/16-16 ORFS	4.4	4.8	4.6	3.4												
37	DMH -303-ORN	3/8" O RING	4.5	4.8	4.6	3.4												
38	DMH - 304F	1/2" SAE	8.5	9	8.6	6												
39	DMH - 304S	1/2" ODF	10.5	10.9	10.6	7.5												
40	DMH - 304R	13/16-16 ORFS	10.5	9	8.6	6	681	628	668	572	562	446	528	364	646	625		
41	DMH - 305F	5/8" SAE	10.8	11.8	11.3	7.9												
42	DMH - 305S	5/8" ODF	10.8	11.8	11.3	7.9												
43	DMH - 305R	1" -14 ORFS	10.8	11.8	11.3	7.9												
44	DMH - 306F	3/4" SAE	15	16.5	15.7	7.9												
45	DMH - 306S	3/4" ODF	15	16.5	15.7	10.9												
46	DMH - 307S	7/8" ODF	16.9	18.5	17.9	12.5												
47	DMH - 309S	1-1/8" ODF	19.9	21.5	20.8	14.5												
48	DMH - 412 ORN	1/4" O RING	10	11	11	7.3												
49	DMH - 413F	3/8" SAE	10.2	11.2	11.2	7.4												
50	DMH -413S	3/8" ODF	10.3	11.3	11.3	7.5												
51	DMH - 414F	1/2" SAE	10.5	11.5	11.5	7.6												
52	DMH - 414S	1/2" ODF	10.9	11.8	11.8	7.9												
53	DMH - 415F	5/8" SAE	12.5	13.5	12.6	8.8												
54	DMH - 415S	5/8" ODF	12.2	13.6	13	8.8	962	877	934	797	784	623	733	477	897	872		
55	DMH - 415R	1-14 ORFS	12.2	13.6	13	8.8												
56	DMH - 415-4F	5/8"SAE(IN) & 1/2 SAE(OUT)	10.8	11.5	11.8	7.8												
57	DMH - 415-4R	1-14 ORFS (IN) & 13/16-16 ORFS(OUT)	10.8	11.5	11.5	7.9												
58	DMH - 416-5R	1"-1/4 ORFS (IN) & 1"-14 ORFS (OUT)	12.4	13.8	13.2	9												
59	DMH - 417S	7/8" ODF	20.5	22.5	21.8	14.9												
60	DMH - 419S	1-1/8" ODF	27.8	30.5	29.8	20.5												
61	DMH -757S	7/8"ODF	23.4	25.7	23.8	17.1	2214	2072	2194	1905	1855	1496	1490	1140	2068	2072		
62	DMH - 759S	1-1/8 ODF	26.8	29.1	34.8	19.40												

All ratings are in accordance with ANSI/AHRI Standard 710-2009
 1. Water Capacities are based on following standard rating conditions :
 Water in refrigerant at EPD for :
 R-134a/R-407C/R-410A/R-404A/R-507A is 50 ppm,
 R-22 is 60 ppm.

2. Flow Capacities are based on following standard rating conditions :
 Flow Rate per Ton of Refrigeration at 86°F Liquid & 5.0°F Saturated Vapor for :
 R-134a is 3.1 lb/min/ton,
 R-407C is 3.0 lb/min/ton,
 R-410A is 2.8 lb/min/ton,
 R-404A is 4.1 lb/min/ton,
 R-507A is 4.2 lb/min/ton,
 R-22 is 3.0 lb/min/ton.

LIQUID LINE FILTER DRIER DMHSG SERIES (WITH SIGHT GLASS)

IMAGES & DRAWINGS



File No. SA33181



Filter Drier with SAE connection & Sight Glass



Filter Drier with ODF connection & Sight Glass



Internal View

DIMENSIONAL DATA

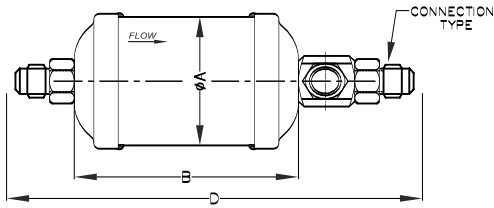

DRAWING - 1

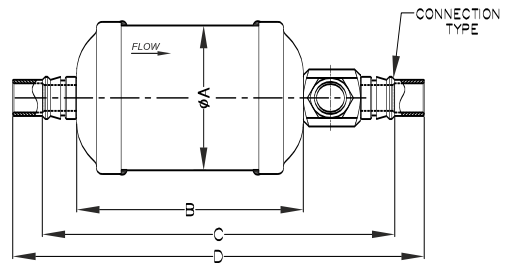

DRAWING - 2

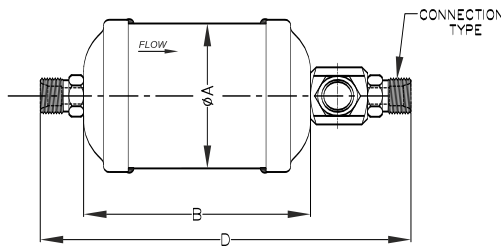

DRAWING - 3

LIQUID LINE FILTER DRIER DMHSG SERIES (WITH SIGHT GLASS)



MODEL AVAILABLE

Sr No.	Model	Connection Type	Outer Dia ϕ A		Body Length B		Stopper To Stopper Length C		Overall Length D		Refer Drawing No.		
			mm	inch	mm	inch	mm	inch	mm	inch			
1	DMHSG-052F	1/4" SAE	Ø63.5	Ø2.5	78	3.07	--	--	162	6.37	DRAWING - 1		
2	DMHSG-052S*	1/4" ODF					146	5.75	166	6.54	DRAWING - 2		
3	DMHSG-053F	3/8" SAE					--	--	170	6.69	DRAWING - 1		
4	DMHSG-053S*	3/8" ODF					146	5.75	166	6.54	DRAWING - 2		
5	DMHSG-082F	1/4" SAE					--	--	183	7.21	DRAWING - 1		
6	DMHSG-082S*	1/4" ODF					167	6.57	187	7.36	DRAWING - 2		
7	DMHSG-083F	3/8" SAE			99	3.90	--	--	191	7.52	DRAWING - 1		
8	DMHSG-083S*	3/8" ODF					167	6.57	187	7.36	DRAWING - 2		
9	DMHSG-084F	1/2" SAE					--	--	197	7.76	DRAWING - 1		
10	DMHSG-084S*	1/2" ODF					167	6.57	193	7.60	DRAWING - 2		
11	DMHSG-163F	3/8" SAE					--	--	214	8.43	DRAWING - 1		
12	DMHSG-163S*	3/8" ODF					190	7.48	210	8.26	DRAWING - 2		
13	DMHSG-164F	1/2" SAE			122	4.80	--	--	220	8.66	DRAWING - 1		
14	DMHSG-164S*	1/2" ODF					190	7.48	216	8.51	DRAWING - 2		
15	DMHSG-164-ORN	1/2" O-Ring					--	--	205	8.07	DRAWING - 3		
16	DMHSG-165F	5/8" SAE	--	--			228	8.98	DRAWING - 1				
17	DMHSG-165S*	5/8" ODF	190	7.48			220	8.66	DRAWING - 2				
18	DMHSG-303F	3/8" SAE	Ø76.2	Ø3			190	7.48	--	--	282	11.11	DRAWING - 1
19	DMHSG-303S*	3/8" ODF			258	10.16			278	10.95	DRAWING - 2		
20	DMHSG-304F	1/2" SAE			--	--			288	11.34	DRAWING - 1		
21	DMHSG-304S*	1/2" ODF			258	10.16			284	11.18	DRAWING - 2		
22	DMHSG-305F	5/8" SAE			--	--			296	11.66	DRAWING - 1		
23	DMHSG-305S*	5/8" ODF			258	10.16			288	11.34	DRAWING - 2		
24	DMHSG-306F	3/4" SAE			--	--	302	12.13	DRAWING - 1				
25	DMHSG-306S*	3/4" ODF			258	10.16	296	11.66	DRAWING - 2				
26	DMHSG-307S*	7/8" ODF			260	10.24	304	11.97	DRAWING - 2				
27	DMHSG-309S*	1-1/8" ODF			260	10.24	314	12.36	DRAWING - 2				
28	DMHSG-414F	1/2" SAE			Ø88.9	Ø4	196	7.80	--	--	296	11.66	DRAWING - 1
29	DMHSG-414S*	1/2" ODF							266	10.47	292	11.49	DRAWING - 2
30	DMHSG-415F	5/8" SAE							--	--	304	11.97	DRAWING - 1
31	DMHSG-415S*	5/8" ODF							266	10.47	296	11.66	DRAWING - 2
32	DMHSG-417S*	7/8" ODF							268	10.56	312	12.28	DRAWING - 2
33	DMHSG-419S*	1-1/8" ODF	268	10.56					322	12.67	DRAWING - 2		

- 1) Internal Assembly - Bead Type
- 2) Maximum Working Pressure - 45 bar (653 psig)
- 3) SAE, ORFS & 'O'Ring Type Connection are in Steel, Nickel Plated
- 4) All ODF Type Connection is in Steel & Nickel Plate
- 5) *Mark Connection Steel Plated

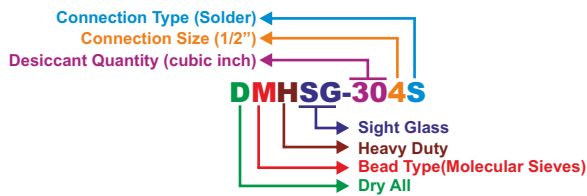

LIQUID LINE FILTER DRIER DMHSG SERIES (WITH SIGHT GLASS)

SELECTION RECOMMENDATION



Model	Connections Type	Flow Capacity Ton @ 1psiΔP (for kw multiply Ton by 3.5)				Water Capacity drops of water									
		R-134a	R-22 & R-410A	R-407C	R-404A & R-507	R-134a		R-22		R-407C		R-410A		R-404A & R-507	
						75°F	125°F	75°F	125°F	75°F	125°F	75°F	125°F	75°F	125°F
DMHSG - 052F	1/4" SAE	2.5	2.4	2.5	1.8	121	110	116	99	100	80	66	61	123	110
DMHSG - 052S	1/4" ODF	3.5	3.6	3.5	2.5										
DMHSG - 053F	3/8" SAE	3.5	3.8	3.8	2.5										
DMHSG - 053S	3/8" ODF	4.6	4.8	4.8	3.5	265	245	250	225	205	165	170	130	275	260
DMHSG - 082F	1/4" SAE	2.4	2.6	2.5	1.9										
DMHSG - 082S	1/4" ODF	3	3.5	3.5	2.5										
DMHSG - 083F	3/8" SAE	4	4.5	4.5	3										
DMHSG - 083S	3/8" ODF	4.5	4.9	4.9	3.5										
DMHSG - 084F	1/2" SAE	6.7	7.5	7	5										
DMHSG - 084S	1/2" ODF	7.1	7.7	7.5	5	384	348	375	320	312	246	212	194	359	348
DMHSG - 163F	3/8" SAE	4	4.2	4.2	3										
DMHSG - 163S	3/8" ODF	4.5	4.8	4.7	3.2										
DMHSG - 164F	1/2" SAE	8.5	9.5	9.2	6.2										
DMHSG - 164S	1/2" ODF	8.5	9.5	9	6.2										
DMHSG - 164-ORN	1/2" O - Ring	8.5	9.2	9	6.2										
DMHSG - 165F	5/8" SAE	9.7	10.5	10.3	7	681	628	668	572	562	446	528	364	646	625
DMHSG - 165S	5/8" ODF	10.1	10.9	10.7	7.3										
DMHSG - 303F	3/8" SAE	4.5	4.8	4.6	3.5										
DMHSG - 303S	3/8" ODF	6.4	6.8	6.7	4.8										
DMHSG - 304F	1/2" SAE	8.5	9	8.6	6										
DMHSG - 304S	1/2" ODF	10.5	10.9	10.6	7.5										
DMHSG - 305F	5/8" SAE	10.8	11.8	11.3	7.9										
DMHSG - 305S	5/8" ODF	10.8	11.8	11.3	7.9										
DMHSG - 306F	3/4" SAE	15	16.5	15.7	7.9										
DMHSG - 306S	3/4" ODF	15	16.5	15.7	10.9										
DMHSG - 307S	7/8" ODF	16.9	18.5	17.9	12.5										
DMHSG - 309S	1-1/8" ODF	19.9	21.5	20.8	14.5	962	877	934	797	784	623	733	477	897	872
DMHSG - 414F	1/2" SAE	10.5	11.5	11.5	7.6										
DMHSG - 414S	1/2" ODF	10.9	11.8	11.8	7.9										
DMHSG - 415F	5/8" SAE	12.5	13.5	12.6	8.8										
DMHSG - 415S	5/8" ODF	12.2	13.6	13	8.8										
DMHSG - 417S	7/8" ODF	20.5	22.5	21.8	14.9										
DMHSG - 419S	1-1/8" ODF	27.8	30.5	29.8	20.5										

All ratings are in accordance with ANSI/AHRI Standard 710-2009

1. Water Capacities are based on following standard rating conditions :

Water in refrigerant at EPD for :

R-134a/R-407C/R-410A/R-404A/R-507A is 50 ppm,

R-22 is 60 ppm.

2. Flow Capacities are based on following standard rating conditions :

Flow Rate per Ton of Refrigeration at 86°F Liquid & 5.0°F Saturated Vapor for :

R-134a is 3.1 lb/min/ton,

R-407C is 3.0 lb/min/ton,

R-410A is 2.8 lb/min/ton,

R-404A is 4.1 lb/min/ton,

R-507A is 4.2 lb/min/ton,

R-22 is 3.0 lb/min/ton.

LIQUID LINE FILTER DRIER DCH SERIES (SOLID CORE TYPE)

IMAGES



03-SERIES



05-SERIES



08-SERIES



16-SERIES

Internal View



30-SERIES



41-SERIES

Filter Drier with SAE connection



Filter Drier with ODF connection

LIQUID LINE FILTER DRIER DCH SERIES (SOLID CORE TYPE)

DRAWINGS



DIMENSIONAL DATA		
DRAWING -1	DRAWING -2	DRAWING -3
DRAWING -4	DRAWING -5	DRAWING -6
DRAWING -7	DRAWING -8	DRAWING -9
DRAWING -10	DRAWING -11	DRAWING -12

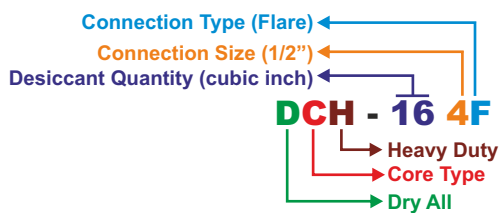

LIQUID LINE FILTER DRIER DCH SERIES (SOLID CORE TYPE)

MODELS AVAILABLE



Sr No.	Model	Connection Type	Outer Dia ØA		Body Length B		Stopper To Stopper Length C		Overall Length D		Refer Drawing No.				
			mm	inch	mm	inch	mm	inch	mm	inch					
1	DCH - 032F	1/4" SAE	Ø 42	Ø 1.6	67	2.64	--	--	113	4.45	DRAWING - 1				
2	DCH - 032FF	1/4" SAE (F/M)					--	--	102	4.01	DRAWING - 9				
3	DCH - 032S	1/4" ODF					97	3.82	117	4.61	DRAWING - 2				
4	DCHSV - 032F	1/4" SAE					--	--	113	4.45	DRAWING - 8				
5	DCHSV - 032S	1/4" ODF					97	3.82	117	4.61	DRAWING - 7				
6	DCH-033F	3/8" SAE					--	--	121	4.76	DRAWING - 1				
7	DCH - 033S	3/8" ODF					97	3.82	117	4.61	DRAWING - 2				
8	DCH - 052F	1/4" SAE					Ø 63.5	Ø 2.5	78	3.07	--	--	124	4.88	DRAWING - 3
9	DCH - 052S	1/4" ODF									108	4.25	128	5.04	DRAWING - 4
10	DCH - 053F	3/8" SAE									--	--	132	5.20	DRAWING - 3
11	DCH - 053S	3/8" ODF									108	4.25	128	5.04	DRAWING - 4
12	DCH - 053R	11/16-16 ORFS									--	--	116	4.56	DRAWING - 5
13	DCH - 082F	1/4" SAE	--	--	145	5.71					DRAWING - 3				
14	DCH- 082S	1/4" ODF	129	5.08	149	5.87					DRAWING - 4				
15	DCH - 083F	3/8" SAE	99	3.90	--	--					153	6.02	DRAWING - 3		
16	DCH - 083S	3/8" ODF			129	5.08					149	5.87	DRAWING - 4		
17	DCH - 084F	1/2" SAE			--	--					159	6.26	DRAWING - 3		
18	DCH - 084S	1/2" ODF			129	5.08					149	5.87	DRAWING - 4		
19	DCH - 163F	3/8" SAE			122	4.80					--	--	176	6.93	DRAWING - 3
20	DCH - 163S	3/8" ODF					152	5.98	172	6.77	DRAWING - 4				
21	DCH - 163R	11/16-16 ORFS					--	--	160	6.30	DRAWING - 5				
22	DCH - 164F	1/2" SAE					--	--	182	7.17	DRAWING - 3				
23	DCH - 164S	1/2" ODF					152	5.98	172	6.77	DRAWING - 4				
24	DCH - 164R	13/16-16 ORFS					--	--	162	6.38	DRAWING - 5				
25	DCH - 165F	5/8" SAE					--	--	190	7.48	DRAWING - 3				
26	DCH - 165S	5/8" ODF					152	5.98	172	6.77	DRAWING - 4				
27	DCH - 165R	1"-14 ORFS	--	--			176	6.93	DRAWING - 5						
28	DCHLD - 162R	9/16-18 ORFS	Ø 76.2	Ø 3			110	4.33	--	--	148	5.83	DRAWING - 5		
29	DCHLD - 163F	3/8" SAE							--	--	164	6.46	DRAWING - 3		
30	DCHLD - 163R	11/16-16 ORFS							--	--	148	5.83	DRAWING - 5		
31	DCHLD - 163RL	11/16-16 ORFS			113	4.44			--	--	177	6.97	DRAWING - 12		
32	DCHLD - 164R	13/16-16 ORFS			110	4.33			--	--	150	5.91	DRAWING - 5		
33	DCHLD - 164 ORF	1/2" SAE			--	--			176	6.93	DRAWING - 10				
34	DCH - 303F	3/8" SAE			190	7.48			--	--	244	9.61	DRAWING - 3		
35	DCH - 303S	3/8" ODF							220	8.66	240	9.45	DRAWING - 4		
36	DCH - 303R	11/16-16 ORFS							--	--	228	8.98	DRAWING - 5		
37	DCH -303-ORN	3/8" 'O' RING							--	--	244	9.61	DRAWING - 11		
38	DCH - 304F	1/2" SAE							--	--	250	9.84	DRAWING - 3		
39	DCH - 304S	1/2" ODF							220	8.66	240	9.45	DRAWING - 4		
40	DCH - 304R	13/16-16 ORFS	--	--			230	9.06	DRAWING - 5						
41	DCH-304 ORF	1/2"-SAE (Groove)	--	--			256	10.08	DRAWING - 10						
42	DCH - 305F	5/8" SAE	--	--			258	10.08	DRAWING - 3						
43	DCH - 305S	5/8" ODF	220	8.66			240	9.45	DRAWING - 4						
44	DCH - 305R	1"-14 ORFS	--	--			244	9.61	DRAWING - 5						
45	DCH-305 ORN	5/8" 'O' RING	--	--			250	9.45	DRAWING - 11						
46	DCH - 306F	3/4" SAE	--	--	264	10.39	DRAWING - 3								
47	DCH - 306S	3/4" ODF	220	8.66	240	9.45	DRAWING - 4								
48	DCH - 307S*	7/8" ODF	220	8.66	264	10.39	DRAWING - 6								
49	DCH - 309S*	1-1/8" ODF	220	8.66	274	10.79	DRAWING - 6								
50	DCH - 413F	3/8" SAE	Ø 88.9	Ø 3.5	198	7.80	--	--	258	10.15	DRAWING - 3				
51	DCH -413S	3/8" ODF					224.3	8.83	248	9.76	DRAWING - 4				
52	DCH-414-ORF	1/2"-SAE (Flare Groove)					188	7.40	--	--	254	10.00	DRAWING - 10		
53	DCH - 414F	1/2" SAE					--	--	258	10.16	DRAWING - 3				
54	DCH - 414S	1/2" ODF					228	8.98	248	9.76	DRAWING - 4				
55	DCH - 415F	5/8" SAE					198	7.80	--	--	266	10.47	DRAWING - 3		
56	DCH - 415S	5/8" ODF							228	8.98	248	9.76	DRAWING - 4		
57	DCH - 415-4F	5/8" SAE (IN) & 1/2" SAE(OUT)					--	--	262	10.31	DRAWING - 3				
58	DCH - 415-4R	1"-14 ORFS (IN) & 13/16-16 ORFS(OUT)					188	7.40	--	--	235	9.25	DRAWING - 5		
59	DCH - 416-5R	1"-1/4 ORFS (IN) & 1"-1/4 ORFS (OUT)					198	7.80	--	--	255	10.04	DRAWING - 5		
60	DCH-417S*	7/8" ODF							228	8.98	272	10.71	DRAWING - 6		
61	DCH-419*	1-1/8" ODF							228	8.98	282	11.10	DRAWING - 6		
62	DCH -757S*	7/8" ODF	341	13.43	385	15.16			DRAWING - 6						
63	DCH - 759S*	1-1/8" ODF	341	13.43	398	15.67	DRAWING - 6								

- 1) Internal Assembly - Bead Type
- 2) Maximum Working Pressure - 45 bar (653 psig)
- 3) SAE, ORFS & 'O' Ring Type Connection are in Steel, Nickel Plated
- 4) ODF Type Connection is in Copper
- 5) *Mark Connection Steel Plated

LIQUID LINE FILTER DRIER SELECTION RECOMMENDATIONS DCH

SELECTION RECOMMENDATION



Sr No.	Model	Connections Type	Flow Capacity Ton @ 1psi ΔP (for kw multiply Ton by 3.5)				Water Capacity drops of water													
			R-134a	R-22 & R-410A	R-407C	R-404A & R-507	R-134a		R-22		R-407C		R-410A		R-404A & R-507					
							75°F	125°F	75°F	125°F	75°F	125°F	75°F	125°F	75°F	125°F				
1	DCH - 032F	1/4" SAE																		
2	DCH - 032FF	1/4" SAE (F/M)	2	2	2	1.42	80	74	75	69	63	52	53	42	82	78				
3	DCH - 032S	1/4" ODF																		
4	DCHSV - 032F	1/4" SAE																		
5	DCHSV - 032S	1/4" ODF	4.85	4.85	5.42	3.7														
6	DCH-033F	3/8" SAE																		
7	DCH - 033S	3/8" ODF																		
8	DCH - 052F	1/4" SAE	2	2.28	2.28	1.42														
9	DCH - 052S	1/4" ODF																		
10	DCH - 053F	3/8" SAE																		
11	DCH - 053S	3/8" ODF	5.14	5.42	5.42	4	201	186	186	136	156	126	131	101	206	196				
12	DCH - 053R	11/16-16 ORFS																		
13	DCH - 082F	1/4" SAE																		
14	DCH - 082S	1/4" ODF	2	2.28	2.28	1.42														
15	DCH - 083F	3/8" SAE																		
16	DCH - 083S	3/8" ODF																		
17	DCH - 084F	1/2" SAE	5.42	6	6	4	265	245	250	225	205	165	170	130	275	260				
18	DCH - 084S	1/2" ODF																		
19	DCH - 163F	3/8" SAE																		
20	DCH - 163S	3/8" ODF	6.2	6.8	6.8	4.57														
21	DCH - 163R	11/16-16 ORFS																		
22	DCH - 164F	1/2" SAE																		
23	DCH - 164S	1/2" ODF	8.5	9.4	9.4	6.2	396	366	271	336	306	246	256	196	406	286				
24	DCH - 164R	13/16-16ORFS																		
25	DCH - 165F	5/8" SAE																		
26	DCH - 165S	5/8" ODF	12.2	13.4	13.4	8.57														
27	DCH - 165R	1" - 14 ORFS																		
28	DCHLD - 162R	9/16-18 ORFS																		
29	DCHLD - 163F	3/8" SAE	7.4	8	8	5.7														
30	DCHLD - 163R	11/16-16ORFS																		
31	DCHLD - 163RL	11/16-16ORFS																		
32	DCHLD - 164R	13/16-16 ORFS	9.6	10.5	10.5	7.4	490	463	360	342	400	364	350	314	672	364				
33	DCHLD - 164 ORF	1/2" SAE																		
34	DCH - 303F	3/8" SAE																		
35	DCH - 303S	3/8" ODF	6	6.57	6.57	4.28														
36	DCH -303R	11/16-16 ORFS																		
37	DCH -303-ORN	3/8" O RING																		
38	DCH - 304F	1/2" SAE	8.85	9.71	9.71	6.28														
39	DCH - 304S	1/2" ODF																		
40	DCH - 304R	13/16-16 ORFS																		
41	DCH-304 ORF	1/2" SAE (Groove)	12.85	14	14	9.42	877	812	822	752	687	552	567	432	907	857				
42	DCH - 305F	5/8" SAE																		
43	DCH - 305S	5/8" ODF																		
44	DCH - 305R	1" -14 ORFS	17.71	19.42	19.42	12.85														
45	DCH-305 ORN	5/8" 'O' Ring																		
46	DCH - 306F	3/4" SAE																		
47	DCH - 306S	3/4" ODF	17.71	19.42	19.42	12.85														
48	DCH - 307S*	7/8" ODF																		
49	DCH - 309S*	1-1/8" ODF																		
50	DCH - 413F	3/8" SAE	9	10.2	10.2	6.5														
51	DCH -413S	3/8" ODF																		
52	DCH-414-ORF	1/2" SAE (Flare Groove)																		
53	DCH - 414F	1/2" SAE	9.14	10	10	6.57														
54	DCH - 414S	1/2" ODF																		
55	DCH - 415F	5/8" SAE																		
56	DCH - 415S	5/8" ODF	15.14	16.57	16.57	10.57	1216	1106	1146	1016	951	746	786	586	1266	1162				
57	DCH - 415-4F	5/8"SAE(IN) & 1/2 SAE(OUT)																		
58	DCH - 415-4R	1-14 ORFS (IN) & 13/16-16 ORFS(OUT)																		
59	DCH - 416-5R	1"-1/4 ORFS (IN) & 1"-14 ORFS (OUT)	20.57	22.57	22.57	15.57														
60	DCH-417S*	7/8" ODF																		
61	DCH-419*	1-1/8" ODF																		
62	DCH -757S*	7/8"ODF	23.4	26	25.7	17.14	2106	1946	1962	1806	1641	1316	1356	1036	2176	2056				
63	DCH- 759S*	1-1/8" ODF																		

All ratings are in accordance with ANSI/AHRI Standard 710-2009

1. Water in refrigerant at EPD for :

R-134a/R-407C/R-410A/R-404A/R-507A is 50 ppm,

R-22 is 60 ppm.

2. Flow Capacities are based on following standard rating

Flow Rate per Ton of Refrigeration at 86°F Liquid & 5.0°F Saturated Vapor for :

R-134a is 3.1 lb/min/ton,

R-407C is 3.0 lb/min/ton,

R-410A is 2.8 lb/min/ton,

R-404A is 4.1 lb/min/ton,

R-507A is 4.2 lb/min/ton,

R-22 is 3.0 lb/min/ton.

LIQUID LINE FILTER DRIER DCHSG SERIES (WITH SIGHT GLASS)

IMAGES & DRAWINGS

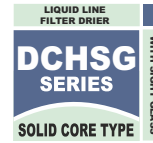

File No. SA33181



Filter Drier with SAE connection & Sight Glass



Filter Drier with ODF connection & Sight Glass



Internal View

DIMENSIONAL DATA

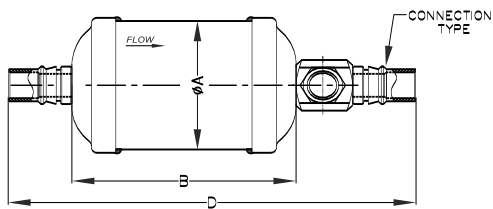

DRAWING - 1

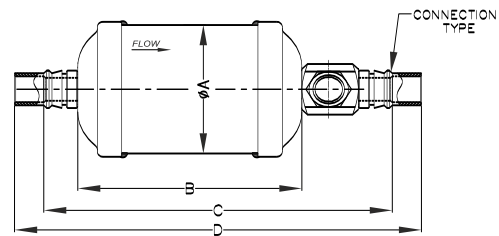

DRAWING - 2

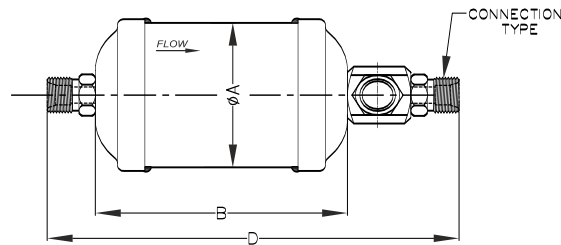

DRAWING - 3

LIQUID LINE FILTER DRIER DCHSG SERIES (WITH SIGHT GLASS)

MODELS AVAILABLE

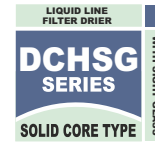

SR NO.	MODEL	CONNECTION TYPE (inch)	OUTER DIA ØA		BODY LENGTH B		STOPPER TO STOPPER LENGTH C		OVERALL LENGTH D		REFER DRAWING NO.		
			mm	inch	mm	inch	mm	inch	mm	inch			
1	DCHSG-052F	1/4" SAE	Ø63.5	Ø2.5	78	3.07	--	--	162	6.38	DRAWING - 1		
2	DCHSG-052S*	1/4" ODF					146	5.75	166	6.54	DRAWING - 2		
3	DCHSG-053F	3/8" SAE					--	--	170	6.69	DRAWING - 1		
4	DCHSG-053S*	3/8" ODF					146	5.75	166	6.54	DRAWING - 2		
5	DCHSG-082F	1/4" SAE			99	3.90	--	--	183	7.20	DRAWING - 1		
6	DCHSG-082S*	1/4" ODF					167	6.57	187	7.36	DRAWING - 2		
7	DCHSG-083F	3/8" SAE					--	--	191	7.52	DRAWING - 1		
8	DCHSG-083S*	3/8" ODF					167	6.57	187	7.36	DRAWING - 2		
9	DCHSG-084F	1/2" SAE					--	--	197	7.76	DRAWING - 1		
10	DCHSG-084S*	1/2" ODF					167	6.57	193	7.60	DRAWING - 2		
11	DCHSG-163F	3/8" SAE					122	4.80	--	--	214	8.43	DRAWING - 1
12	DCHSG-163S*	3/8" ODF							190	7.48	210	8.27	DRAWING - 2
13	DCHSG-164F	1/2" SAE			--	--			220	8.66	DRAWING - 1		
14	DCHSG-164S*	1/2" ODF			190	7.48			216	8.50	DRAWING - 2		
15	DCHSG-164-ORN	1/2" O-Ring			--	--			205	8.07	DRAWING - 3		
16	DCHSG-165F	5/8" SAE			--	--			228	8.98	DRAWING - 1		
17	DCHSG-165S*	5/8" ODF			190	7.48			220	8.66	DRAWING - 2		
18	DCHSG-303F	5/8" ODF	Ø76.2	Ø3	129	5.07			190	7.48	220	8.66	DRAWING - 3
19	DCHSG-303F	3/8" SAE			--	--	282	11.10	DRAWING - 1				
20	DCHSG-303S*	3/8" ODF			258	10.16	278	10.94	DRAWING - 2				
21	DCHSG-304F	1/2" SAE			--	--	288	11.34	DRAWING - 1				
22	DCHSG-304S*	1/2" ODF			258	10.16	284	11.18	DRAWING - 2				
23	DCHSG-305F	5/8" SAE			--	--	296	11.65	DRAWING - 1				
24	DCHSG-305S*	5/8" ODF			258	10.16	288	11.34	DRAWING - 2				
25	DCHSG-306F	3/4" SAE			--	--	302	12.13	DRAWING - 1				
26	DCHSG-306S*	3/4" ODF			258	10.16	296	11.65	DRAWING - 2				
27	DCHSG-307S*	7/8" ODF			260	10.24	304	11.97	DRAWING - 2				
28	DCHSG-309S*	1-1/8" ODF	260	10.24	314	12.36	DRAWING - 2						
29	DCHSG-414F	1/2" SAE	Ø88.9	Ø4	196	7.80	--	--	296	11.65	DRAWING - 1		
30	DCHSG-414S*	1/2" ODF					266	10.47	292	11.50	DRAWING - 2		
31	DCHSG-415F	5/8" SAE					--	--	304	11.97	DRAWING - 1		
32	DCHSG-415S*	5/8" ODF					266	10.47	296	11.65	DRAWING - 2		
33	DCHSG-417S*	7/8" ODF					268	10.55	312	12.28	DRAWING - 2		
34	DCHSG-419S*	1-1/8" ODF					268	10.55	322	12.66	DRAWING - 2		

- 1) Internal Assembly - Bead Type
- 2) Maximum Working Pressure - 45 bar (653 psig)
- 3) SAE, ORFS & 'O'Ring Type Connection are in Steel, Nickel Plated
- 4) ODF Type Connection is in Steel & Nickel Plated
- 5) *Mark Connection Steel Plated

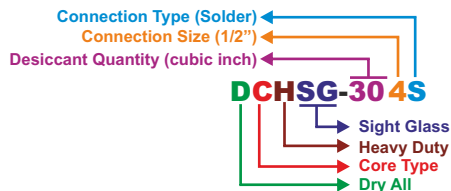

LIQUID LINE FILTER DRIER DCHSG SERIES (WITH SIGHT GLASS)

SELECTION RECCOMENDATION

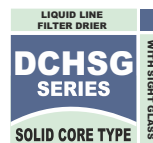

SR NO.	Description	Connections Type	Flow Capacity Ton @ 1psi ΔP (for kw multiply Ton by 3.5)				Water Capacity drops of water									
			R-134a	R-22 & R-410A	R-407C	R-404A & R-507	R-134a		R-22		R-407C		R-410A		R-404A & R-507	
							75°F	125°F	75°F	125°F	75°F	125°F	75°F	125°F	75°F	125°F
1	DCHSG - 052F	1/4" SAE	2	2.28	2.28	1.42	201	186	186	136	156	126	131	101	206	196
2	DCHSG - 052S	1/4" ODF														
3	DCHSG - 053F	3/8" SAE	5.14	5.42	5.42	4										
4	DCHSG - 053S	3/8" ODF														
5	DCHSG - 082F	1/4" SAE	2	2.28	2.28	1.42										
6	DCHSG - 082S	1/4" ODF														
7	DCHSG - 083F	3/8" SAE	5.42	6	6	4	265	245	250	225	205	165	170	130	275	260
8	DCHSG - 083S	3/8" ODF														
9	DCHSG - 084F	1/2" SAE	7.42	8.28	8.28	5.71										
10	DCHSG - 084S	1/2" ODF														
11	DCHSG - 163F	3/8" SAE	6.2	6.8	6.8	4.57										
12	DCHSG - 163S	3/8" ODF														
13	DCHSG - 164F	1/2" SAE	8.5	9.4	9.4	6.2	396	366	271	336	306	246	256	196	406	286
14	DCHSG - 164S	1/2" ODF														
15	DCHSG - 164-ORN	13/16-16ORFS	12.2	13.4	13.4	8.57										
16	DCHSG - 165F	5/8" SAE														
17	DCHSG - 165S	5/8" ODF	9.6	10.5	10.5	7.4	490	463	360	342	400	364	350	314	672	364
18	DCHSG - 163R	11/16-16 ORFS														
19	DCHSG - 303F	3/8" SAE	6	6.57	6.57	4.28										
20	DCHSG - 303S	3/8" ODF														
21	DCHSG - 304F	1/2" SAE	8.85	9.71	9.71	6.28										
22	DCHSG - 304S	1/2" ODF														
23	DCHSG - 305F	5/8" SAE	12.85	14	14	9.42	877	812	822	752	687	552	567	432	907	857
24	DCHSG - 305S	5/8" ODF														
25	DCHSG - 306F	3/4" SAE	17.71	19.42	19.42	12.85										
26	DCHSG - 306S	3/4" ODF														
27	DCHSG - 307S*	7/8" ODF	17.71	19.42	19.42	12.85										
28	DCHSG - 309S*	1-1/8" ODF														
29	DCHSG - 414F	1/2" SAE	9.14	10	10	6.57										
30	DCHSG - 414S	1/2" ODF														
31	DCHSG - 415F	5/8" SAE	15.14	16.57	16.57	10.57	1216	1106	1146	1016	951	746	786	586	1266	1162
32	DCHSG - 415S	5/8" ODF														
33	DCHSG - 417S*	7/8" ODF	26	28.57	28.57	18.57										
34	DCHSG - 419*	1-1/8" ODF														

All ratings are in accordance with ANSI/AHRI Standard 710-2009

1. Water in refrigerant at EPD for :

R-134a/R-407C/R-410A/R-404A/R-507A is 50 ppm,

R-22 is 60 ppm.

2. Flow Capacities are based on following standard rating

Flow Rate per Ton of Refrigeration at 86°F Liquid & 5.0°F Saturated Vapor for :

R-134a is 3.1 lb/min/ton,

R-407C is 3.0 lb/min/ton,

R-410A is 2.8 lb/min/ton,

R-404A is 4.1 lb/min/ton,

R-507A is 4.2 lb/min/ton,

R-22 is 3.0 lb/min/ton.

SUCTION LINE FILTER DRIER DCHSF SERIES (SOLID CORE TYPE)

IMAGES & DRAWINGS

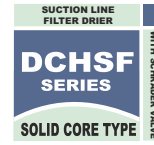

File No. SA33181



DIMENSIONAL DATA

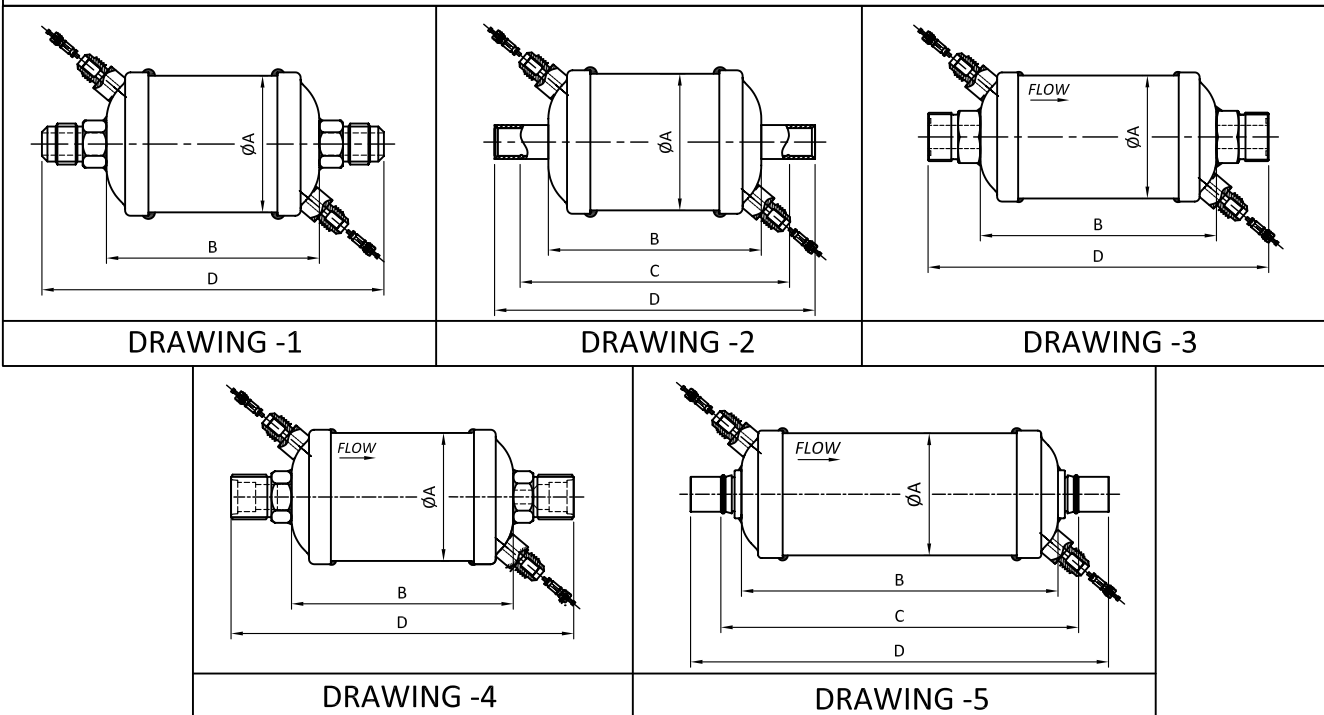

SUCTION LINE FILTER DRIER DCHSF SERIES (SOLID CORE TYPE)

MODELS AVAILABLE

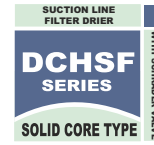

Sr No.	Model	Connection Type	Outer Dia ØA		Body Length B		Stopper to Stopper Length C		Overall Length D		Refer Drawing No.				
			mm	Inch	mm	Inch	mm	Inch	mm	Inch					
1	DCHSF-052F	1/4" SAE	78	3.07	78	3.07	--	--	124	4.88	DRAWING - 1				
2	DCHSF-052S	1/4" ODF					108	4.25	128	5.04	DRAWING - 2				
3	DCHSF-053F	3/8" SAE					--	--	132	5.20	DRAWING - 1				
4	DCHSF-053S	3/8" ODF					108	4.25	128	5.04	DRAWING - 2				
5	DCHSF-082F	1/4" SAE	Ø 63.5	Ø 2.5	99	3.90	--	--	145	5.71	DRAWING - 1				
6	DCHSF-082S	1/4" ODF					129	5.08	149	5.87	DRAWING - 2				
7	DCHSF-083F	3/8" SAE					--	--	153	6.02	DRAWING - 1				
8	DCHSF-083S	3/8" ODF					129	5.08	149	5.87	DRAWING - 2				
9	DCHSF-084F	1/2" SAE					--	--	159	6.26	DRAWING - 1				
10	DCHSF-084S	1/2" ODF					129	5.08	149	5.87	DRAWING - 2				
11	DCHSF-163F	3/8" SAE					Ø 76.2	Ø 3	122	4.80	--	--	176	6.93	DRAWING - 1
12	DCHSF-163S	3/8" ODF									152	5.98	172	6.77	DRAWING - 2
13	DCHSF-163R	11/16-16ORFS									--	--	160	6.29	DRAWING - 3
14	DCHSF-163ORN	3/8" O RING									--	--	176	6.92	DRAWING - 4
15	DCHSF-164F	1/2" SAE	--	--	182	7.17					DRAWING - 1				
16	DCHSF-164S	1/2" ODF	152	5.98	172	6.77					DRAWING - 2				
17	DCHSF-164R	13/16-16ORFS	--	--	170	6.69					DRAWING - 3				
18	DCHSF-165F	5/8" SAE	--	--	190	7.48					DRAWING - 1				
19	DCHSF-165S	5/8" ODF	152	5.98	172	6.77					DRAWING - 2				
20	DCHSF-165R	1"-14 ORFS	--	--	170	6.69					DRAWING - 3				
21	DCHSF-303F	3/8" SAE	Ø 76.2	Ø 3	190	7.48					--	--	244	9.61	DRAWING - 1
22	DCHSF-303S	3/8" ODF									220	8.66	240	9.45	DRAWING - 2
23	DCHSF-303R	11/16-16ORFS					--	--	228	8.97	DRAWING - 3				
24	DCHSF-303ORN	3/8" O RING					--	--	244	9.60	DRAWING - 4				
25	DCHSF-304F	1/2" SAE					--	--	250	9.84	DRAWING - 1				
26	DCHSF-304S	1/2" ODF					220	8.66	240	9.45	DRAWING - 2				
27	DCHSF-304R	13/16-16ORFS					--	--	238	9.37	DRAWING - 3				
28	DCHSF-305F	5/8" SAE					--	--	258	10.16	DRAWING - 1				
29	DCHSF-305S	5/8" ODF					220	8.66	240	9.45	DRAWING - 2				
30	DCHSF-305R	1"-14 ORFS					--	--	244	9.61	DRAWING - 3				
31	DCHSF-306F	3/4" SAE					--	--	270	10.63	DRAWING - 1				
32	DCHSF-306S	3/4" ODF					220	8.66	240	9.45	DRAWING - 2				
33	DCHSF-307S*	7/8" ODF					220	8.66	264	10.39	DRAWING - 5				
34	DCHSF-309S*	1 1/8" ODF					220	8.66	274	10.79	DRAWING - 5				
35	DCHSF-414F	1/2" SAE	Ø 88.9	Ø 3.5	198	7.80	--	--	258	10.16	DRAWING - 1				
36	DCHSF-414S	1/2" ODF					228	8.98	248	9.76	DRAWING - 2				
37	DCHSF-415F	5/8" SAE					--	--	266	10.47	DRAWING - 1				
38	DCHSF-415S	5/8" ODF					228	8.98	248	9.76	DRAWING - 2				
39	DCHSF-415-4F	1/2" SAE(OUT)&5/8 SAE(IN)					--	--	262	10.31	DRAWING - 1				
40	DCHSF-415-4R	13/16-16ORFS(OUT) & 1"-14 ORFS(IN)					--	--	235	9.25	DRAWING - 3				
41	DCHSF-417S*	7/8" ODF					228	8.98	272	10.71	DRAWING - 5				
42	DCHSF-419S*	1-1/8" ODF					228	8.98	282	11.10	DRAWING - 5				

- 1) Internal Assembly - Bead Type
- 2) Maximum Working Pressure - 45 bar (653 psig)
- 3) SAE, ORFS & 'O' Ring Type Connection are in Steel, Nickel Plated
- 4) ODF Type Connection is in Steel & Nickel Plated
- 5) *Mark Connection Steel Plated

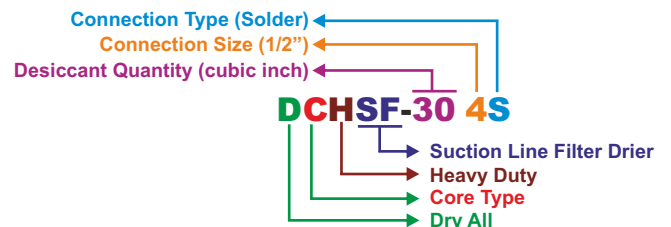

SUCTION LINE FILTER DRIER DCHSF SERIES (SOLID CORE TYPE)

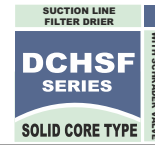

SELECTION RECOMMENDATION

SR NO.	Description	Connections	Flow Capacity Tan @ 1psi ΔP (for kw multiply Ton by 3.5)				Water Capacity drops of water											
			R-134a	R-22 & R-410A	R-407C	R-404A & R-507	R-134a		R-22		R-407C		R-410A		R-404A & R-507			
							75°F	125°F	75°F	125°F	75°F	125°F	75°F	125°F	75°F	125°F		
1	DCHSF - 052F	1/4" SAE	2	2.28	2.28	1.42	201	186	186	136	156	126	131	101	206	196		
2	DCHSF - 052S	1/4" ODF																
3	DCHSF - 053F	3/8" SAE																
4	DCHSF - 053S	3/8" ODF	5.14	5.42	5.42	4												
5	DCHSF - 082F	1/4" SAE	2	2.28	2.28	1.42	265	245	250	225	205	165	170	130	275	260		
6	DCHSF - 082S	1/4" ODF																
7	DCHSF - 083F	3/8" SAE																
8	DCHSF - 083S	3/8" ODF	5.42	6	6	4												
9	DCHSF - 084F	1/2" SAE	7.42	8.28	8.28	5.71	396	366	271	336	306	246	256	196	406	286		
10	DCHSF - 084S	1/2" ODF																
11	DCHSF - 163F	3/8" SAE																
12	DCHSF - 163S	3/8" ODF	6.2	6.8	6.8	4.57	877	812	822	752	687	552	567	432	907	857		
13	DCHSF - 163R	11/16-16 ORFS																
14	DCHSF-163ORN	3/8" O" Ring																
15	DCHSF - 164F	1/2" SAE	8.5	9.4	9.4	6.2	12.85	14	14	9.42	17.71	19.42	19.42	12.85	17.71	19.42	12.85	
16	DCHSF - 164S	1/2" ODF																
17	DCHSF - 164R	13/16-16ORFS																
18	DCHSF - 165F	5/8" SAE	12.2	13.4	13.4	8.57	9.14	10	10	6.57	15.14	16.57	16.57	10.57	26	28.57	28.57	18.57
19	DCHSF - 165S	5/8" ODF																
20	DCHSF-166S	3/4"ODF																
21	DCHSF-167S	7/8"ODF	6	6.57	6.57	4.28	1216	1106	1146	1016	951	746	786	586	1266	1162		
22	DCHSF - 165R	1" - 14 ORFS																
23	DCHSF - 303F	3/8" SAE																
24	DCHSF - 303S	3/8" ODF	8.85	9.71	9.71	6.28	17.71	19.42	19.42	12.85	17.71	19.42	12.85	17.71	19.42	12.85		
25	DCHSF - 303R	11/16-16 ORFS																
26	DCHSF -303-ORN	3/8" O RING																
27	DCHSF - 304F	1/2" SAE	17.71	19.42	19.42	12.85	9.14	10	10	6.57	15.14	16.57	16.57	10.57	26	28.57	28.57	18.57
28	DCHSF - 304S	1/2" ODF																
29	DCHSF - 304R	13/16-16 ORFS																
30	DCHSF - 305F	5/8" SAE	17.71	19.42	19.42	12.85	9.14	10	10	6.57	15.14	16.57	16.57	10.57	26	28.57	28.57	18.57
31	DCHSF - 305S	5/8" ODF																
32	DCHSF - 305R	1" -14 ORFS																
33	DCHSF - 306F	3/4" SAE	17.71	19.42	19.42	12.85	9.14	10	10	6.57	15.14	16.57	16.57	10.57	26	28.57	28.57	18.57
34	DCHSF - 306S	3/4" ODF																
35	DCHSF - 307S*	7/8" ODF																
36	DCHSF - 309S*	1-1/8" ODF	17.71	19.42	19.42	12.85	9.14	10	10	6.57	15.14	16.57	16.57	10.57	26	28.57	28.57	18.57
37	DCHSF - 414F	1/2" SAE																
38	DCHSF - 414S	1/2" ODF																
39	DCHSF - 415F	5/8" SAE	17.71	19.42	19.42	12.85	9.14	10	10	6.57	15.14	16.57	16.57	10.57	26	28.57	28.57	18.57
40	DCHSF - 415S	5/8" ODF																
41	DCHSF - 415-4F	5/8"SAE(IN) & 1/2 SAE(OUT)																
42	DCHSF - 415-4R	1-14 ORFS (IN) & 13/16-16 ORFS(OUT)	17.71	19.42	19.42	12.85	9.14	10	10	6.57	15.14	16.57	16.57	10.57	26	28.57	28.57	18.57
43	DCHSF-417S*	7/8" ODF																
44	DCHSF-419*	1-1/8" ODF																

All ratings are in accordance with ANSI/AHRI Standard 710-2009

1. Water in refrigerant at EPD for :

R-134a/R-407C/R-410A/R-404A/R-507A is 50 ppm,

R-22 is 60 ppm.

2. Flow Capacities are based on following standard rating

Flow Rate per Ton of Refrigeration at 86°F Liquid & 5.0°F Saturated Vapor for :

R-134a is 3.1 lb/min/ton,

R-407C is 3.0 lb/min/ton,

R-410A is 2.8 lb/min/ton,

R-404A is 4.1 lb/min/ton,

R-507A is 4.2 lb/min/ton,

R-22 is 3.0 lb/min/ton.

BI - FLOW FILTER DRIER DCHBF SERIES (BI - DIRECTION)

IMAGE, DRAWINGS & MODELS AVAILABLE



File No. SA33181

Bi-Flow Filter Drier with SAE Connection

Internal View

DIMENSIONAL DATA

DRAWING - 1

DRAWING - 2

DRAWING - 3

DRAWING - 4

Sr No.	Model	Connection Type	Outer Dia ϕ A		Body Length B		Stopper To Stopper Length C		Overall Length D		Refer Drawing No.				
			mm	Inch	mm	Inch	mm	Inch	mm	Inch					
1	DCHBF-052F	1/4" SAE	63.5	2.5	76	2.99	--	--	122	4.80	DRAWING - 1				
2	DCHBF-052S	1/4" ODF					106	4.17	126	4.96	DRAWING - 2				
3	DCHBF-053F	3/8" SAE					--	--	130	5.12	DRAWING - 1				
4	DCHBF-053S	3/8" ODF					102.3	4.03	126	4.96	DRAWING - 2				
5	DCHBF-082F	1/4" SAE	63.5	2.5	97	3.82	--	--	143	5.63	DRAWING - 1				
6	DCHBF-082S	1/4" ODF					127	5.00	147	5.79	DRAWING - 2				
7	DCHBF-083F	3/8" SAE					--	--	151	5.94	DRAWING - 1				
8	DCHBF-083S	3/8" ODF					123.3	4.85	147	5.79	DRAWING - 2				
9	DCHBFSG-083 ORN	3/8" 'O' RING	63.5	2.5	97	3.82	--	--	180	7.09	DRAWING - 4				
10	DCHBF-084F	1/2" SAE					--	--	157	6.18	DRAWING - 1				
11	DCHBF-084S	1/2" ODF					123.3	4.85	147	5.79	DRAWING - 2				
12	DCHBF-163F	3/8" SAE					76.2	3	117	4.61	--	--	171	6.73	DRAWING - 1
13	DCHBF-163S	3/8" ODF	143.3	5.64	167	6.57					DRAWING - 2				
14	DCHBF-164F	1/2" SAE	--	--	177	6.97					DRAWING - 1				
15	DCHBF-164S	1/2" ODF	143.3	5.64	167	6.57					DRAWING - 2				
16	DCHBF-165F	5/8" SAE	76.2	3	117	4.61	--	--	185	7.28	DRAWING - 1				
17	DCHBF-165S	5/8" ODF					143.3	5.64	167	6.57	DRAWING - 2				
18	DCHBF-303F	3/8" SAE					76.2	3	191	7.52	--	--	245	9.65	DRAWING - 1
19	DCHBF-303S	3/8" ODF									217.3	8.56	241	9.49	DRAWING - 2
20	DCHBF-304F	1/2" SAE	--	--	251	9.88					DRAWING - 1				
21	DCHBF-304S	1/2" ODF	217.3	8.56	241	9.49					DRAWING - 2				
22	DCHBF-305F	5/8" SAE	76.2	3	191	7.52	--	--	259	10.20	DRAWING - 1				
23	DCHBF-305S	5/8" ODF					217.3	8.56	241	9.49	DRAWING - 2				
24	DCHBF-306F	3/4" SAE					--	--	265	10.43	DRAWING - 1				
25	DCHBF-306S	3/4" ODF					217.3	8.56	241	9.49	DRAWING - 2				
26	DCHBF-3075*	7/8" ODF	76.2	3	191	7.52	221	8.70	265	10.43	DRAWING - 3				
27	DCHBF-3095*	1 1/8" ODF					221	8.70	275	10.83	DRAWING - 3				

- 1) Internal Assembly - Bead Type
- 2) Maximum Working Pressure - 45 bar (653 psig)
- 3) SAE, ORFS & 'O' Ring Type Connection are in Steel, Nickel Plated
- 4) ODF Type Connection is in Steel & Nickel Plated
- 5) *Mark Connection Steel Plated

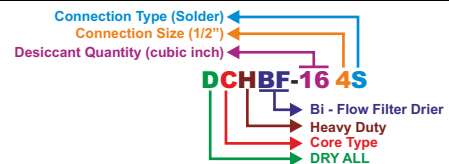

BI - FLOW FILTER DRIER DCHBF SERIES (BI - DIRECTION)

SELECTION RECOMENDATION



Sr. No.	Model	Connections	Flow Capacity* Tov @ 1psi ΔP (for kW, multiply Ton by 3.5)				Water Capacity drops of water									
			R-134a	R-22	R-407C & R-410A	R-404 & R-507	R-134a		R-22		R-407C		R-410A		R-404A & R-507	
							75°F	125°F	75°F	125°F	75°F	125°F	75°F	125°F	75°F	125°F
1	DCHBF-052F	1/4 SAE	2.2	2.2	2.2	1.37	201	186	186	136	156	126	131	101	206	196
2	DCHBF-052S	1/4 ODF														
3	DCHBF-053F	3/8 SAE	4	4	3.9	2.73	265	245	250	225	205	165	170	130	275	260
4	DCHBF-053S	3/8 ODF														
5	DCHBF-082F	1/4 SAE	4.3	4.3	4.3	2.8	359	341	360	307	361	333	327	302	392	365
6	DCHBF-082S	1/4 ODF														
7	DCHBF-083F	3/8 SAE	4.8	5.1	5	3.33	877	812	822	752	687	552	567	432	907	857
8	DCHBF-083S	3/8 ODF														
9	DCHBFG-083 ORN	3/8" ORN	6.2	6.7	6.7	4.62	17.71	16	16	10.38	17.79	18	18	11.95		
10	DCHBF-084F	1/2 SAE														
11	DCHBF-084S	1/2 ODF	6	5.8	5.8	3.7	8.84	9.7	9.7	6.23	12.84	14.2	14.2	9.43		
12	DCHBF-163F	3/8 SAE														
13	DCHBF-163S	3/8 ODF	7.9	8.1	8.1	5.34	17.71	16	16	10.38	17.79	18	18	11.95		
14	DCHBF-164F	1/2 SAE														
15	DCHBF-164S	1/2 ODF	8.3	8.7	8.7	5.56	17.71	16	16	10.38	17.79	18	18	11.95		
16	DCHBF-165F	5/8 SAE														
17	DCHBF-165S	5/8 ODF	6	5.8	5.8	3.7	8.84	9.7	9.7	6.23	12.84	14.2	14.2	9.43		
18	DCHBF-303F	3/8 SAE														
19	DCHBF-303S	3/8 ODF	8.84	9.7	9.7	6.23	12.84	14.2	14.2	9.43	17.71	16	16	10.38		
20	DCHBF-304F	1/2 SAE														
21	DCHBF-304S	1/2 ODF	12.84	14.2	14.2	9.43	17.71	16	16	10.38	17.79	18	18	11.95		
22	DCHBF-305F	5/8 SAE														
23	DCHBF-305S	5/8 ODF	17.71	16	16	10.38	17.79	18	18	11.95						
24	DCHBF-306F	3/4 SAE														
25	DCHBF-306S	3/4 ODF	17.79	18	18	11.95										
26	DCHBF-307S*	7/8 ODF														
27	DCHBF-309S*	1 1/8 ODF														

All ratings are in accordance with ANSI/AHRI Standard 710-2009

1. Water in refrigerant at EPD for :

R-134a/R-407C/R-410A/R-404A/R-507A is 50 ppm,

R-22 is 60 ppm.

2. Flow Capacities are based on following standard rating conditions

Flow Rate per Ton of Refrigeration at 86 °F Liquid & 5.0°F Saturated Vapor for :

R-134a is 3.1 lb/min/ton,

R-407C is 3.0 lb/min/ton,

R-410A is 2.8 lb/min/ton,

R-404A is 4.1 lb/min/ton,

R-507A is 4.2 lb/min/ton,

R-22 is 3.0 lb/min/ton.

INTERNAL WORKING OF BI-FLOW FILTER DRIER

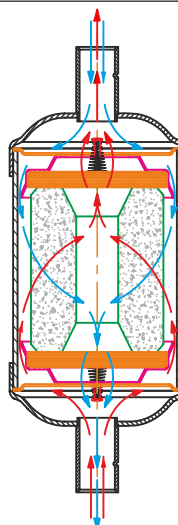

SUCTION LINE FILTER DSF SERIES

IMAGE, DRAWINGS & MODEL AVAILABLE



DIMENSIONAL DATA

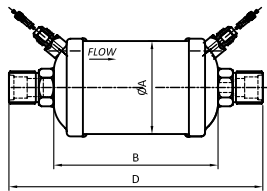

DRAWING -1

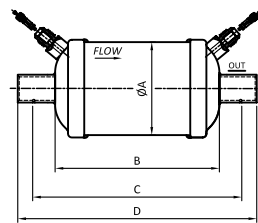

DRAWING -2

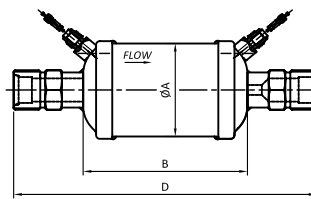

DRAWING -3

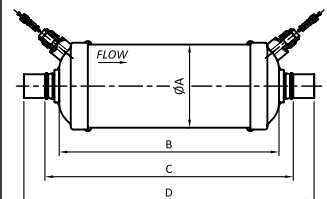

DRAWING -4

SR NO.	MODEL	CONNECTION TYPE (inch)	OUTER DIA ØA		BODY LENGTH B		STOPPER TO STOPPER LENGTH C		OVERALL LENGTH D		REFER DRAWING NO.
			mm	inch	mm	inch	mm	inch	mm	inch	
1	DSF-163S	3/8"ODF	63.5	2.5	110	4.34	136.3	5.37	160	6.3	DRAWING -2
2	DSF-164S	1/2" ODF	63.5	2.5	110	4.34	136.3	5.37	160	6.3	DRAWING -2
3	DSF-165S	5/8" ODF	63.5	2.5	110	4.34	136.3	5.37	160	6.3	DRAWING -2
4	DSF-165ORN	5/8" O RING	63.5	2.5	110	4.34	136.3	5.37	170	6.7	DRAWING -1
5	DSF-166ORN	3/4" O RING	63.5	2.5	110	4.34	136.3	5.37	203	8	DRAWING -3
6	DSF-415S	5/8" ODF	88.9	3.5	159	6.25	189	7.44	209	8.2	DRAWING -2
7	DSF-416S	3/8"ODF	88.9	3.5	159	6.25	189	7.44	209	8.2	DRAWING -2
8	DSF-417S	7/8"ODF	88.9	3.5	159	6.25	189	7.44	233	9.2	DRAWING -4
9	DSF-419S	1"-1/8 ODF	88.9	3.5	159	6.25	189	7.44	243	9.6	DRAWING -4

- 1) Internal Assembly - Bead Type
- 2) Maximum Working Pressure - 45 bar (653 psig)
- 3) SAE, ORFS & 'O'Ring Type Connection are in Steel, Nickel Plated
- 4) ODF Type Connection is in Steel & Nickel Plated
- 5) *Mark Connection Steel Plated

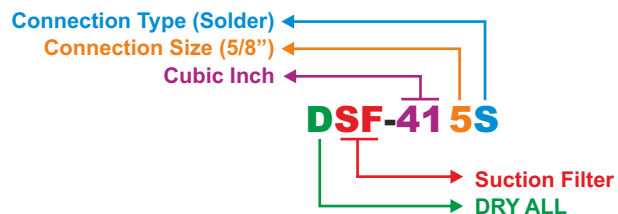

FILTER DRIER FOR BUS AC & TRUCK REFRIGERATION

DRIER SERIES

REF UNITS & BUS AC DRIERS			
Sr. No	Connection Size	Type	Dry All Model No.
1	3/8" x 3/8" ORFS	Solid Core	DCHLD-163R
2	1/2" x 1/2" ORFS	Solid Core	DCHLD-164R
3	3/8" x 3/8" ORFS	Solid Core	DCHLD-163RL
4	5/8" x 1/2" ORFS	Solid Core	DCH-415-4R
5	1/2" x 1/2" Flare	Solid Core	DCH-414F
6	5/8" x 1/2	Solid Core	DCH-415-4Flare
7	1/2 x 1/2" Flare-Groove	Solid Core	DCH-305R
8	1/2" x 1/2" Flare-Groove	Solid Core	DCH-414ORF
9	1/2" x 1/2" Flare-Groove	Solid Core	DCHLD-164ORF
10	3/8" x 3/8" ORFS	Solid Core	DCH-303R
11	1/2" x 1/2" ORFS	Solid Core	DCH-304R
12	1/4" x 1/4" ORFS	Solid Core	DCHLD-162R
13	3/8" x 3/8" Flare	Solid Core	DCH-303F
14	3/8" x 3/8" Flare	Solid Core	DCH-163F
15	1/2" x 1/2" Flare	Solid Core	DCH-164F
16	3/8" x 3/8" Flare	Solid Core	DCH-083F
17	1/2" x 1/2" Flare	Solid Core	DCH-304F
18	5/8" x 5/8" Flare	Solid Core	DCH-305F



Connection Nomenclature	
F	Flare Connection
S	Solder Connection
R	Rotolock Connection
ORN	'O' Ring
RL	Rotolock 'L' Type
ORF	'O' Ring Connection

Filter Drier With Tracer Wafer

SPECTROLINE®
HVAC/R

World's
First &
Only

Filter Drier with

Filter Drier Pre-Charged with Fluorescent Dye
To help you find the exact source of Refrigerant Leak

Drier Model Series C-Inch by Dry All	Recommended for Tonnage TR	Approximate Oil Charge in such system in Liters
3	1.4 to 3.3 TR	0.8 to 1.4L
5	1.8 to 4.8 TR	1.4 to 2.0L
8	1.9 to 7.7 TR	1.5 to 3.5L
16	3 to 10.9 TR	2.0 to 4.0L
30	3.5 to 21.5 TR	2.0 to 6.0L
41	7.3 to 30.5 TR	2.5 to 7.5L

500:1 is the recommended dilution ratio for effective fluorescent leak detection. To be checked with UV LED Torch and yellow glasses.

- OEM-Approved PAG dye that is OEM approved
- Compatibility with all Refrigerants
- Universal / Ester A/C dyes will not impair Lubricant properties
- Meets SAE Standard J2297
- Ideal for preventative maintenance and diagnostics
- Quickly find the exact source of small, multiple and intermittent Leaks
- Leak Detection from distance
- Technicians can safely search near moving parts
- Saves Time on your Service Call
- Conserves Expensive Refrigerant and Fluids

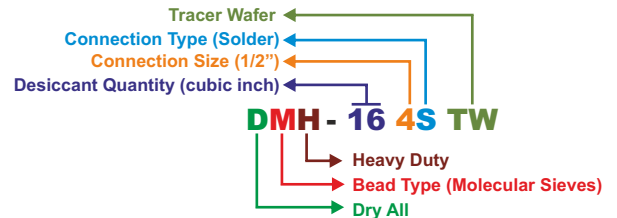

* Available in all models of Filter Drier

REPLACEABLE CORE SHELL

IMAGE, DRAWING & MODELS AVAILABLE

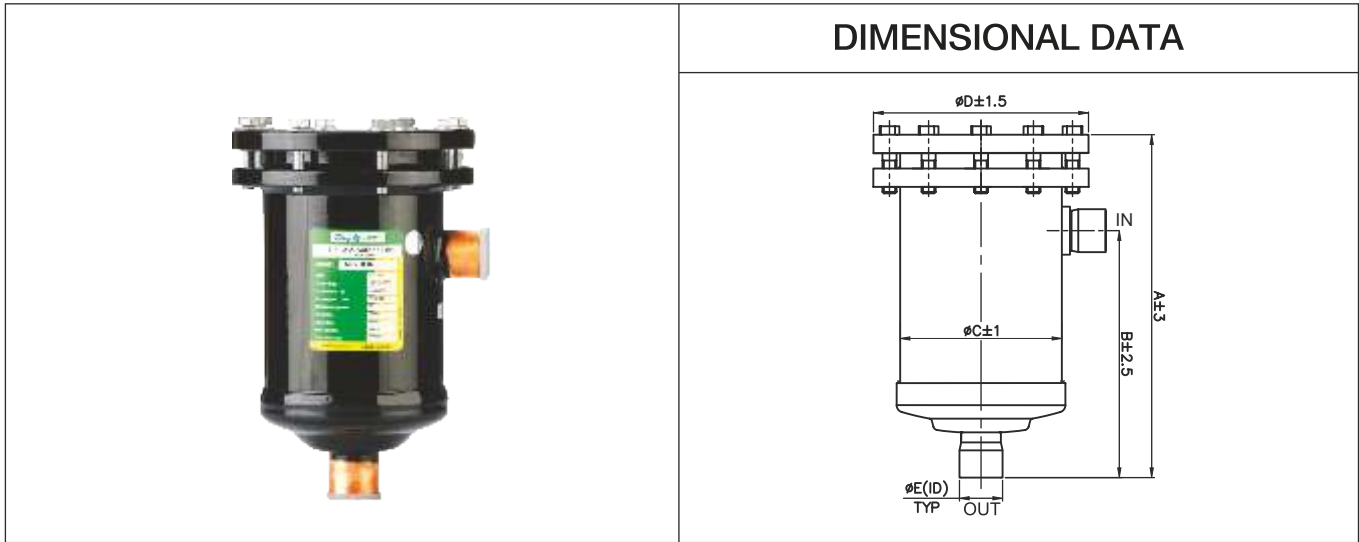

Sr. No.	Model No.	Connection Type	A		B		ϕC		D		Qty for Cores	Liquid Flow Capacity for R-22 in Tons @1 psi
			(mm)	(inch)	(mm)	(inch)	(mm)	(inch)	(mm)	(inch)		
1	DRC - 485S	5/8"	235	9.25	158	6.22	114	4.49	152	5.98	1	21
2	DRC - 487S	7/8"	240	9.45	163	6.42	114	4.49	152	5.98	1	38
3	DRC - 489S	1-1/8"	242	9.53	165	6.50	114	4.49	152	5.98	1	53
4	DRC - 4811S	1-3/8"	242	9.53	165	6.50	114	4.49	152	5.98	1	61
5	DRC - 4813S	1-5/8"	242	9.53	165	6.50	114	4.49	152	5.98	1	85
6	DRC - 4817S	2-1/8"	250	9.84	163	6.42	114	4.49	152	5.98	1	120
7	DRC - 965S	5/8"	385	15.16	303	11.93	114	4.49	152	5.98	2	22
8	DRC - 967S	7/8"	387	15.24	308	12.13	114	4.49	152	5.98	2	41
9	DRC - 969S	1-1/8"	387	15.24	310	12.20	114	4.49	152	5.98	2	63
10	DRC - 9611S	1-3/8"	387	15.24	310	12.20	114	4.49	152	5.98	2	79
11	DRC - 9613S	1-5/8"	387	15.24	310	12.20	114	4.49	152	5.98	2	85
12	DRC - 9617S	2-1/8"	395	15.55	308	12.13	114	4.49	152	5.98	2	120
13	DRC - 9621S*	2-5/8"	406.5	16.00	303.5	11.95	114	4.49	152	5.98	2	97
14	DRC - 9624S	3"	403	15.87	300	11.81	114	4.49	152	5.98	2	68
15	DRC - 1449S	1-1/8"	529	20.83	452	17.80	114	4.49	152	5.98	3	51
16	DRC - 14411S	1-3/8"	529	20.83	452	17.80	114	4.49	152	5.98	3	88
17	DRC - 14413S	1-5/8"	529	20.83	452	17.80	114	4.49	152	5.98	3	97
18	DRC - 14417S	2-1/8"	537	21.14	450	17.72	114	4.49	152	5.98	3	112
19	DRC - 19211S	1-3/8"	679	26.73	602	23.70	114	4.49	152	5.98	4	94
20	DRC - 19213S	1-5/8"	679	26.73	602	23.70	114	4.49	152	5.98	4	103
21	DRC - 19217S	2-1/8"	687	27.05	600	23.62	114	4.49	152	5.98	4	115
22	DRC - 19221S*	2-5/8"	692.5	27.26	589.5	23.21	114	4.49	152	5.98	4	112
23	DRC - 19224S*	3"	689	27.13	586	23.07	114	4.49	152	5.98	4	117

- 1) Maximum Working Pressure - 45 bar (653 psig)
- 2) Temperature Range : -40°C to +70°C
- 3) *Mark Connection Steel & Nickel Plated
- 4) 1/4" NPT Connection is Available in Dry All Core Shell

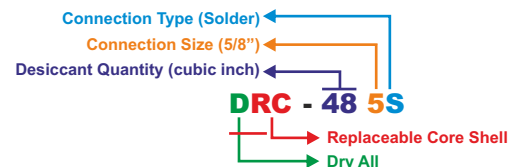

SUCTION LINE FILTER & REPLACEABLE FILTER DRIER CORE

IMAGES, DRAWINGS & MODELS AVAILABLE

Replaceable Core



80% Molecular Sieves+
20% Activated Alumina

100% Molecular Sieves+

48% Molecular Sieves+
47% Activated Alumina+
5% Activated Carbon

DIMENSIONAL DATA

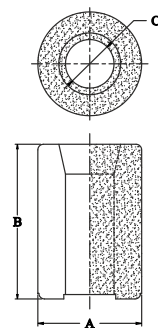

DRAWING - 1

SR NO.	MODEL NO.	DIMENSIONS						REFER DRAWING NO.
		A		B		C		
		(mm)	(inch)	(mm)	(inch)	(mm)	(inch)	
SERIES 1 (REPLACEABLE FILTER DRIER CORE)								
1	DA-48	95	3.74	140	5.51	60	2.36	1
2	DB-48	95	3.74	140	5.51	60	2.36	1
3	DC-48	95	3.74	140	5.51	60	2.36	1
4	DC-100	123	4.85	160	6.30	50	1.97	1

Replaceable Filter



DIMENSIONAL DATA

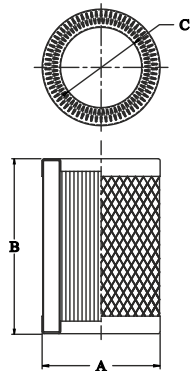

DRAWING - 2

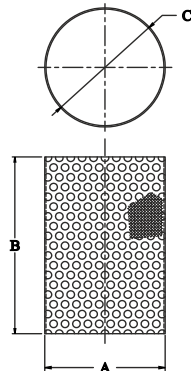

DRAWING - 3

SR NO.	MODEL NO.	DIMENSIONS						REFER DRAWING NO.
		A		B		C		
		(mm)	(inch)	(mm)	(inch)	(mm)	(inch)	
SERIES 2 (REPLACEABLE FILTER DRIER CORE)								
1	DPE-48-BD	90	3.54	140	5.51	60	2.56	2
2	DSS-48	95	3.54	140	5.51	NA	NA	3

SUCTION LINE ACCUMULATOR

LISTED
 File No. SA45127

 Full Range of HVAC&R Line Products

IMAGES, DRAWINGS



Mounting Stud



Mounting Flange

DIMENSIONAL DATA

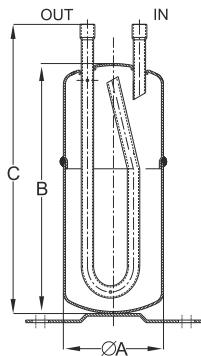
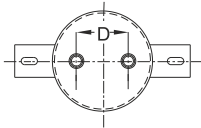

DRAWING - 1

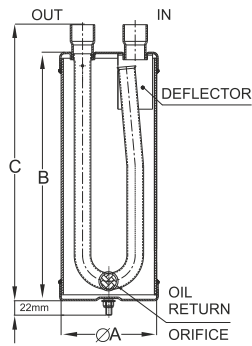
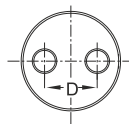

DRAWING - 2

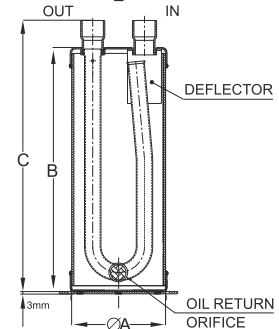
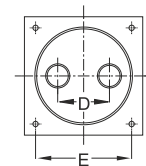

DRAWING - 3

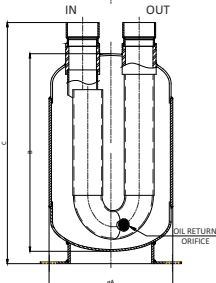
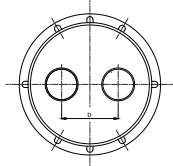

DRAWING - 5

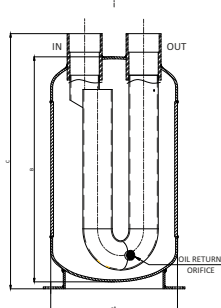
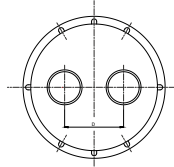

DRAWING - 6

SUCTION LINE ACCUMULATOR

MODEL AVAILABLE &

SELECTION RECOMMENDATION



SR NO	MODEL	HOLDING CAPACITY at +40°F		APPROX. MAX. TON. R-410A AT +40°F (EVAPORATING TEMP)	CONNECTION SIZE (inch)	DIMENSIONS										MOUNTING OPTIONS	REFER DRG. NO.	1/4" NPT connection					
		R-410A LIQUID LBS	R-410A LIQUID KG			ØA		B		C		D		E									
						mm	inch	mm	inch	mm	inch	mm	inch	mm	inch								
SERIES - Ø 3"																							
1	ACC-3150-3S	1.1	0.50	0.5	3/8" ODF	76.2	3	150	5.91	187	7.36	40	1.57	122.5	4.82	MOUNTING FLANGE	1	NA					
2	ACC-3185-4S	1.5	0.68	0.94	1/2" ODF			185	7.28	223	8.78												
3	ACC-3239-5S	2	0.91	2.1	5/8" ODF			239	9.41	277	10.91			41	1.65				NA	NA	M8 X 1.25PITCH	2	
4	ACC-3349-6S	2.8	1.27	3.15	3/4" ODF			349	13.74	387	15.24												
5	ACC-3370-4S	3	1.36	0.94	1/2" ODF			370	14.57	408	16.06												
SERIES - Ø 4"																							
6	ACC-4254-4S	3.53	1.6	0.94	1/2" ODF	101.6	4	254	10	290	11.41	48	1.89	NA	NA	M10 X 1.5 PITCH	2	NA					
7	ACC-4254-5S			2.1	5/8" ODF																		
SERIES - Ø 5"																							
8	ACC-5216-6S	5	2.26	3.15	3/4" ODF	127	5	216	8.51	252	9.92	70	2.76	NA	NA	M10 X 1.5 PITCH	2	NA					
9	ACC-5216-7S	5	2.26	4.2	7/8" ODF					330	12.99			253.5	9.98	130	5.12		MOUNTING FLANGE	3			
10	ACCM-5216-7S	5	2.26	4.2	7/8" ODF									253.5	9.98	130	5.12		MOUNTING FLANGE	3			
11	ACC-5330-7S	7.5	3.40	4.2	7/8" ODF			330	12.99	367.5	14.46			NA	NA	M10 X 1.5 PITCH	2						
12	ACCM-5330-7S													130	5.12	MOUNTING FLANGE	3						
13	ACC-5330-9S	7.5	3.40	9.45	1-1/8" ODF			430	16.93	467.5	18.41			NA	NA	M10 X 1.5 PITCH	2						
14	ACCM-5330-9S													130	5.12	MOUNTING FLANGE	3						
15	ACC-5430-9S	10	4.54	9.45	1-1/8" ODF			430	16.93	467.5	18.41			NA	NA	M10 X 1.5 PITCH	2						
16	ACCM-5430-9S													130	5.12	MOUNTING FLANGE	3						
17	ACC-5430-11S	10	4.54	17.8	1-3/8" ODF			430	16.93	474.5	18.68			NA	NA	M10 X 1.5 PITCH	2						
18	ACCM-5430-11S													130	5.12	MOUNTING FLANGE	3						
SERIES - Ø 6"																							
19	ACC-6330-7S	11	4.99	4.2	7/8" ODF			152.4	6	330	12.99			366.5	14.43	70	2.76		NA	NA	M10 X 1.5 PITCH	2	NA
20	ACCM-6330-7S			130	5.12														MOUNTING FLANGE	3			
21	ACC-6330-9S	11	4.99	9.45	1-1/8" ODF														430	16.93	466.5	18.36	
22	ACCM-6330-9S			130	5.12					MOUNTING FLANGE	3												
23	ACC-6430-7S	14.5	6.58	4.2	7/8" ODF					430	16.93			466.5	18.36				NA	NA	M10 X 1.5 PITCH	2	
24	ACCM-6430-7S			130	5.12														MOUNTING FLANGE	3			
25	ACC-6430-9S			9.45	1"- 1/8 ODF	NA	NA					M10 X 1.5 PITCH	2										
26	ACCM-6430-9S			130	5.12	MOUNTING FLANGE	3																
27	ACC-6430-11S			17.8	1-3/8" ODF	NA	NA					M10 X 1.5 PITCH	2										
28	ACCM-6430-11S			130	5.12	MOUNTING FLANGE	3																
29	ACC-6430-13S	29.4	1"-5/8 ODF	489	19.25	NA	NA			M10 X 1.5 PITCH	2												
30	ACCM-6430-13S					130	5.12			MOUNTING FLANGE	3												
SERIES - Ø 8"																							
31	ACCM-8350-17S	24.2	11		2 - 1/8" ODF	219	8			350	13.8	427	16.8	100	3.9			-	-	MOUNTING FLANGE	5	NA	
SERIES - Ø 10"																							
32	ACCM-105485-21S	51.6	23.4		2 - 5/8" ODF	273	10			485	19	550	21.7	127	5			-	-	MOUNTING FLANGE	6	NA	

- 1) Mounting Flange Shown As 'M' In Model Number, With 4 Holes Of Ø7mm Available On Customer Request As Shown In Drawing - 3
- 2) For Holding Capacity Of R-134A, Multiply R-410a Capacity By 1.11 For R-22, Multiply R-410a Capacity By 1.09 & For R-404a, Multiply R-410a Capacity By 0.98
- 3) The Refrigerant Holding Capacity Of Dry All Accumulator Is Based On Average Condition Of More Than 50% Fill Under Running Condition
- 4) When Selecting Or Sizing An Accumulator Connections May Not Necessarily Match The Suction Line Size
- 5) Maximum Working Pressure - 25bar (355psig) Approx..
- 6) Fusible Plug Available On Specific Models

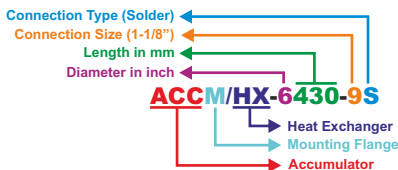

SUCTION LINE ACCUMULATOR WITH HEAT EXCHANGER



DIMENSIONAL DATA

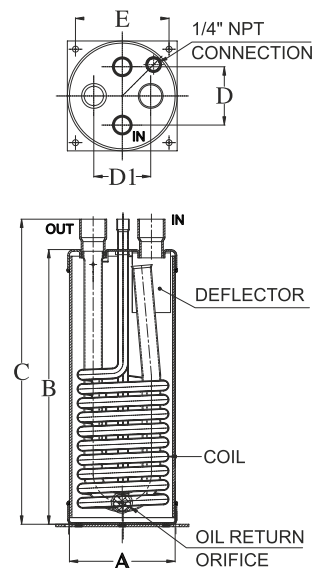

Dry All Model	Holding capacity for R410A Liquid (Kg)	Connection Size (inch)	Heat Exchanger Coil Conn Size	Dimensions										Mounting details
				ØA		B		C		D1		D		
				mm	inch	mm	inch	mm	inch	mm	inch	mm	inch	
ACCHX-4254-4S	1.5	1/2 ODS	3/8 ODS	102	4	254	10	290	11.42	48	1.89	64	2.50	M10 X 1.5 Pitch
ACCHX-4254-5S	1.5	5/8 ODS	3/8 ODS	102	4	254	10	290	11.42	48	1.89	64	2.50	M10 X 1.5 Pitch
ACCMHX-5330-7S	3.2	7/8 ODS	1/2 ODS	127	5	330	13	368	14.47	70	2.76	70	2.76	Mounting Flange
ACCMHX - 6430-9S	6.5	1-1/8 ODS	5/8 ODS	152	6	430	17	467	18.37	70	2.76	70	2.76	Mounting Flange
ACCMHX-6635- 11S	7.5	1-3/8 ODS	5/8 ODS	152	6	635	25	679	26.71	70	2.76	70	2.76	Mounting Flange
ACCMHX-6635- 13S	7.5	1-5/8 ODS	3/4 ODS	152	6	635	25	694	27.32	70	2.76	70	2.76	Mounting Flange

*Note-Mounting Flange for 4" ACCHX Model is available as per customer requirement

Maximum working pressure = 450 psig.

Temperature Range: -40°C To +80°C.

Compatible with R134A, R22, R404A ,

R410A, R407C etc.

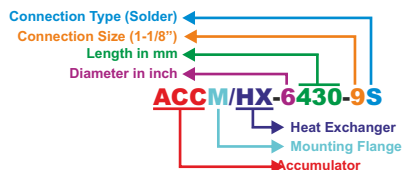

LIQUID REFRIGERANT RECEIVER (HORIZONTAL)

IMAGE, DRAWING & MODEL AVAILABLE



DIMENSIONAL DATA

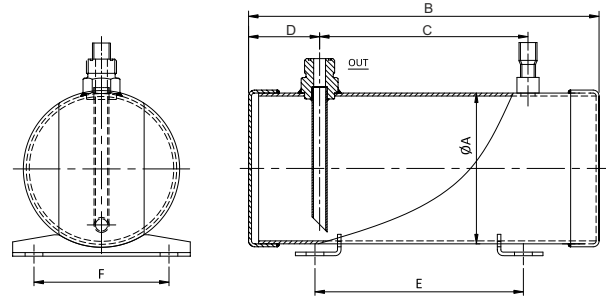

Sr. No.	Model No.	Internal Volume Capacity Liters	Pump Down Capacity (Kg)	Suggested Connection Sizes		Dimensions										Mounting Options	Refer Drawing No.	1/4" NPT Connections								
						ØA		B		C		D		E					F							
				Inlet	Outlet	mm	inch	mm	inch	mm	inch	mm	inch	mm	inch				mm	inch	mm	inch				
1	LRRH - 5296-3S	3	3	3/8" ODF	1"-14 UNS	127	5	296	11.66	176	6.93	60	2.36	176	6.93	114	4.48	MOUNTING BRACKET WITH Ø15mm HOLES X 4nos.	H1	CR						
2	LRRH - 5376-3S	4	4					376	14.81	256	10.08			256	10.08											
3	LRRH - 5456-3S	5	5					456	17.96	336	13.23			336	13.23											
4	LRRH - 5536-3S	6	6					536	21.11	416	16.37			416	16.37											
5	LRRH - 5566-4S	6	7	1/2" ODF	1"-14 UNS	127	5	566	21.88	436	17.16	60	2.36	436	17.16	114	4.48				MOUNTING BRACKET WITH Ø15mm HOLES X 4nos.	H1	CR			
6	LRRH - 6465-4S	7	8					465	18.31	345	13.58			345	13.58											
7	LRRH - 6526-4S	8	9					526	21.71	406	15.98			406	15.98											
8	LRRH - 6587-4S	9	10					587	23.12	467	18.38			467	18.38											
9	LRRH - 6648-5S	10	11	5/8" ODF	1-1/4"-12 UNF	152.4	6	648	25.52	528	20.78	60	2.36	528	20.78	140	5.53							MOUNTING BRACKET WITH Ø15mm HOLES X 4nos.	H1	CR
10	LRRH - 6709-5S	11	12					709	27.92	589	23.18			589	23.18											
11	LRRH - 6770-5S	12	13					770	30.32	650	25.59			650	25.59											
12	LRRH - 6800-5S	13	13					800	31.49	680	26.77			680	26.77											

*RECEIVER WITH NPT CONNECTION ARE ALSO PROVIDED AS PER CUSTOMER REQUIREMENT

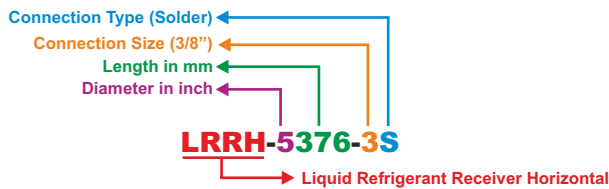

LIQUID REFRIGERANT RECEIVER (VERTICAL)

IMAGES, DRAWINGS & MODELS AVAILABLE

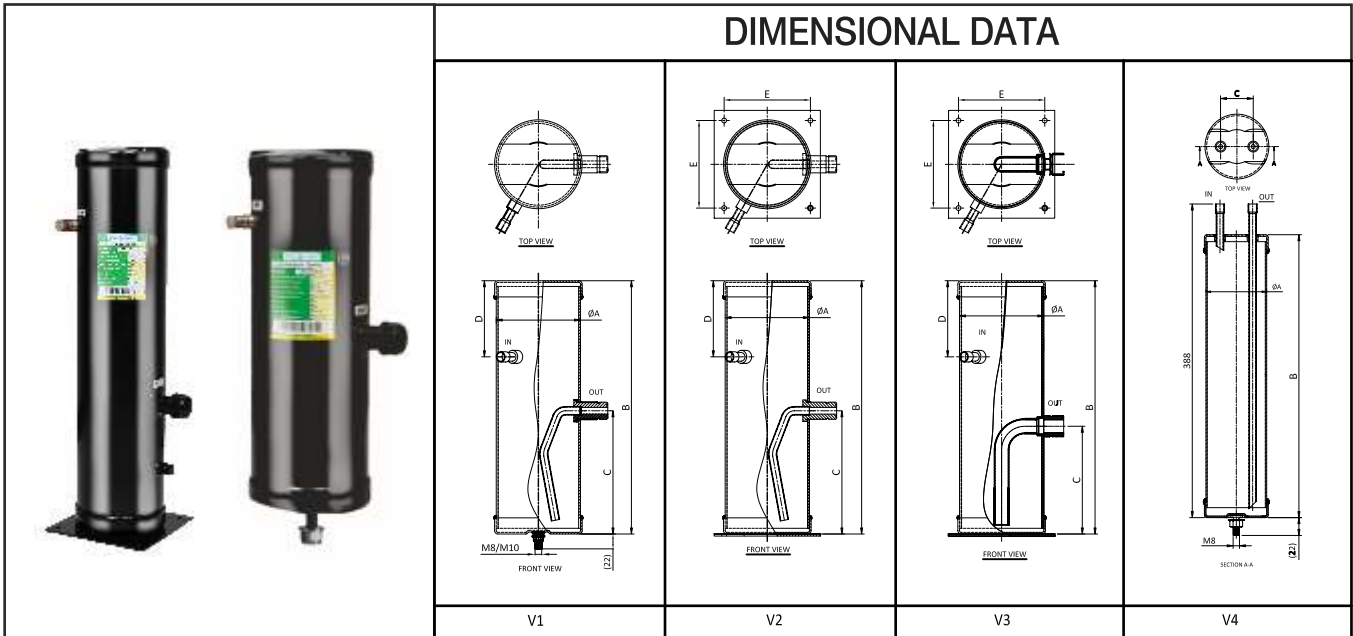

SERIES 1 (Side Inlet & Side Outlet)																		
Sr. No.	Model No.	Internal Volume Capacity (Liters)	Pump Down Capacity (KG)	Connection Sizes		Dimensions								Mounting Option	Refer Drawing No.	Liquid Indicator		
				Inlet	Outlet	øA		B		C		D					E	
						mm	inch	mm	inch	mm	inch	mm	inch	mm	inch			
1	LRRV-3482-3S	2	2	3/8" ODF (STEEL)	1"-14 UNS	76.2	3	482	18.87	175	6.88	80	3.14	NA	NA	M8 X 1.25 Bolt & Nut	V1	NA
2	LRRV-5296-3S	3	3			296	11.65	127	5	376	14.81	183	7.20					
3	LRRV-5376-3S	4	4			376	14.81			74	2.91							
4	LRRV-5456-4S	5	5	1/2" ODF (STEEL)	1"-14 UNS	127	5	456	17.96	183	7.20	86	3.38	130	5.12	Mounting Flange	V2	CR
5	LRRV-5536-4S	6	6					536	21.11			106	4.17					
6	LRRV-5566-4S	6	6					566	22.28			111	4.37					
7	LRRV-6465-4S	7	7	5/8" ODF (STEEL)	1"-14 UNS	152.4	6	465	18.31	160	6.29	93	3.66	130	5.12	Mounting Flange	V2	CR
8	LRRV-6526-4S	8	8					526	20.71			106	4.17					
9	LRRV-6587-4S	9	9					587	23.12			117	4.60					
10	LRRV-6648-5S	10	10	5/8" ODF (STEEL)	1-1/4"-12 UNF	152.4	6	648	25.52	160	6.29	128	5.03	130	5.12	Mounting Flange	V2	CR
11	LRRV-6709-5S	11	11					709	27.92			139	5.47					
12	LRRV-6770-5S	12	12					770	30.32			150	5.90					
13	LRRV-6800-5S	13	13	5/8" ODF (STEEL)	1-1/4"-12 UNF	152.4	6	800	31.49	160	6.29	160	6.29	130	5.12	Mounting Flange	V3	CR
SERIES 2 (Top Dish Inlet & Outlet)																		
1	LRRV-3350-3S	1	1	3/8" ODF (COPPER)	3/8" ODF (COPPER)	76.2	3	350	13.78	41	1.62	NA	NA	NA	NA	M8 X 1.25 Bolt & Nut	V4	NA

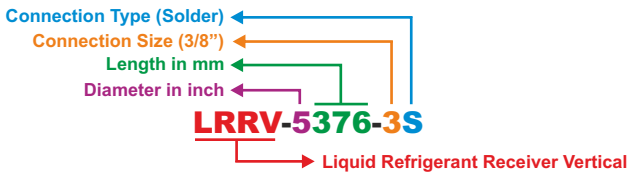

LIQUID REFRIGERANT RECEIVER (DEEP DRAW TYPE)

IMAGE, DRAWINGS & MODELS AVAILABLE



DIMENSIONAL DATA

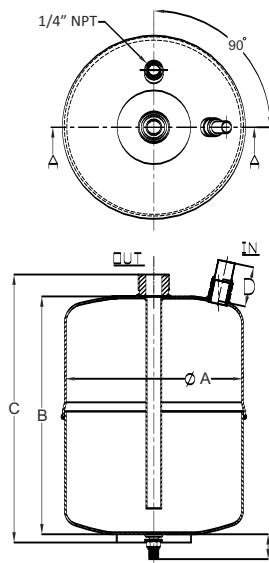

DRAWING-1

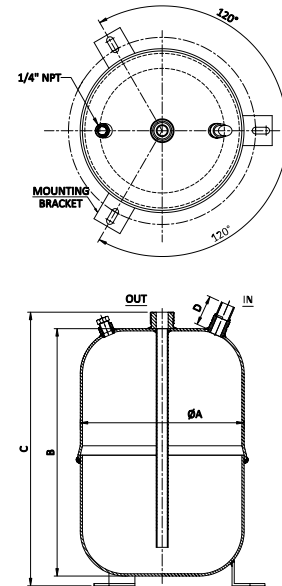

DRAWING-2

Liquid Refrigerant Receiver Deep Draw Type

Sr. No.	Model No.	Internal Volume (Capacity) Liters	Pump Down Capacity (KG)	Connection Sizes		Dimension								Mounting Options	Refer Drawing No.	NPT Conn.	Liquid Indicator
				Inlet	Outlet \ Rotolock Valve	ØA		B		C		D					
						mm	inch	mm	inch	mm	inch	mm	inch				
1	LRRVD-36-180-3S	1	0.92	3/8" ODF	1"-14 UNS \ 3/8" ODF	91	3.58	180	7.09	210	8.27	53	2.09	M10X1.5 BOLT & NUT	1	NA	
2	LRRVD-47-210-3S	2	1.84	3/8" ODF	1"-14 UNS \ 3/8" ODF	120	4.72	210	8.27	240	9.45	53	2.09				
3	LRRVD-59-270-4S	4	3.69	1/2" ODF	1"-14 UNS \ 1/2" ODF	150	5.91	270	10.63	300	11.81	55	2.17				
4	LRRVD-70-240-5S	6	5.53	5/8" ODF	1-1/4"-12 UNF \ 5/8" ODF	180	7.09	240	9.45	270	10.63	40	1.57				
5	LRRVD-70-300-5S	8	7.37	5/8" ODF	1-1/4"-12 UNF \ 5/8" ODF	180	7.09	300	11.81	332	13.07	40	1.57	Three leg mounting	2	1/4"	
6	LRRVD-86-309-5S	10	10.35	5/8" ODF	1-1/4"-12 UNF \ 5/8" ODF	219	8.62	300	11.81	348	13.70	40	1.57				
7	LRRVD-86-349-6S	12	12.42	3/4" ODF	1-1/4"-12 UNF \ 3/4" ODF	219	8.62	350	13.78	400	15.75	42	1.65				

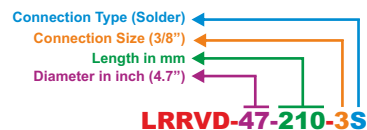

LRRVD-47-210-3S

Liquid Refrigerant Receiver Vertical Deep Draw Type

OIL SEPARATOR

IMAGE, DRAWING & MODEL AVAILABLE



File No. SA44851

DIMENSIONAL DATA

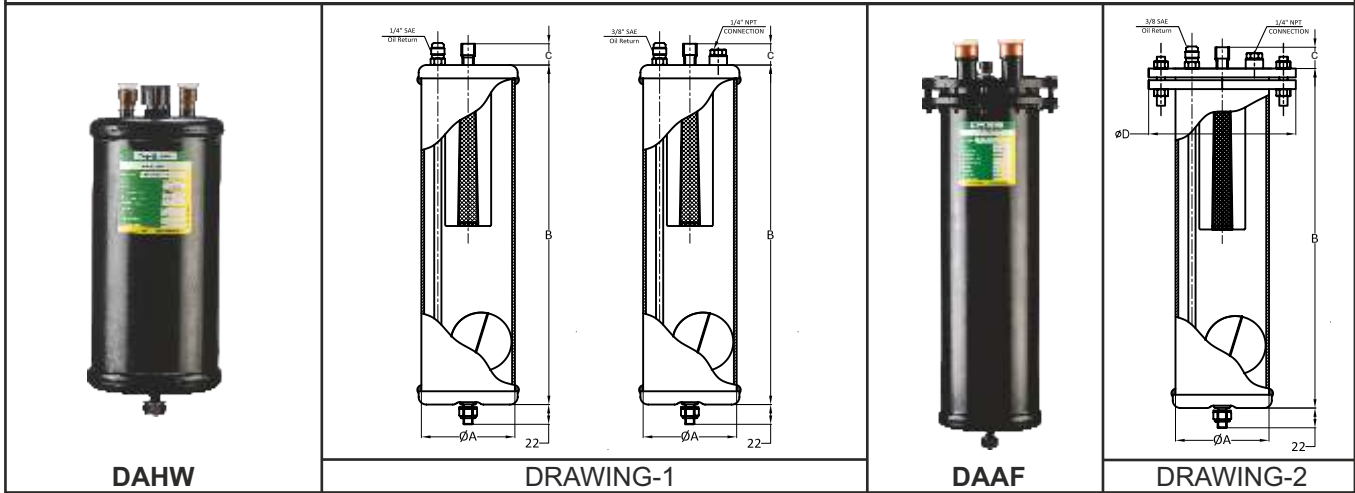

Sr. No.	Model	Connection Size In & Out	Oil Return Connection	Dimension								Mounting Option	Oil Charge Amount	Refer Drawing No.
				ØA		B		C		D				
				mm	Inch	mm	Inch	mm	Inch	mm	Inch			
HERMETIC WELDED TYPE														
1	DAHW-5582-3S	3/8" ODF	1/4" SAE	101.6	4	160	6.3	26	1.02	NA	NA	M10 X 1.5 BOLT WITH WASHER & NUT	500 ml	1
2	DAHW-5582-4S	1/2" ODF	3/8" SAE	101.6	4	250	9.84	37	1.46					1
3	DAHW-5585-5S	5/8" ODF		101.6	4	297	11.69	38	1.50					
4	DAHW-5587-7S	7/8" ODF		101.6	4	344	13.54	37	1.46					
5	DAHW-5588-9S	1-1/8" ODF		101.6	4	375	14.76	37	1.46					
ACCESSIBLE BOLTED FLANGE TYPE														
1	DAAF-5585-5S	5/8" ODF	3/8" SAE	101.6	4	335	13.19	35	1.38	142	5.59	M10 X 1.5 BOLT WITH WASHER & NUT	500 ml	2
2	DAAF-5587-7S	7/8" ODF		101.6	4	416	16.38	40	1.57	142	5.59			
3	DAAF-5588-9S	1-1/8" ODF		101.6	4	498	19.6	42	1.65	142	5.59			

Model No.	Maximum Capacity of Refrigerant at Evaporator Temperature.															
	R-134a				R-22/R-407C				R-404A/R-502/R-507				R-410A			
	-40°F/-40°C		+40°F/4°C		-40°F/-40°C		+40°F/4°C		-40°F/-40°C		+40°F/4°C		-40°F/-4°C		+40°F/4°C	
	Tons	kw	Tons	kw	Tons	kw	Tons	kw	Tons	kw	Tons	kw	Tons	kw	Tons	kw
DAHW - 5582 - 3S	0.8	2.81	1.0	3.51	1.0	3.51	1.5	5.27	1.0	3.51	1.5	5.27	1.7	6.0	2.1	7.3
DAHW - 5582 - 4S	1.2	4.2	1.8	6.3	1.5	5.25	2	7	1.5	5.25	2	7	2.7	9.5	3.1	10.9
DAHW - 5585 - 5S	3.3	11.55	4.5	15.75	4.5	15.75	5.5	19.25	4	14	5.5	19.25	7.3	25.7	8.4	29.5
DAHW - 5587 - 7S	4.8	16.8	6.5	22.75	7	24.5	8	28	6.5	22.75	8.5	29.75	9	31.7	10.5	36.9
DAHW - 5588 - 9S	6.5	22.75	8.5	29.75	9	31.5	11	38.5	8.5	29.75	11	38.5	14	49.2	16	56.3
DAAF - 5585 - 5S	3.3	11.55	4.6	16.1	4.7	16.45	5.6	19.6	4.76	16.66	5.6	19.6	7.3	25.7	8.4	29.5
DAAF - 5587 - 7S	4.8	16.8	6.7	23.45	7	24.5	8.5	29.75	7.15	25.025	8.5	29.75	9	31.7	10.5	36.5
DAAF - 5588 - 9S	6.5	22.75	8.7	30.45	9.5	33.25	11	38.5	9.52	33.32	11.2	39.2	14	49.2	16	56.3

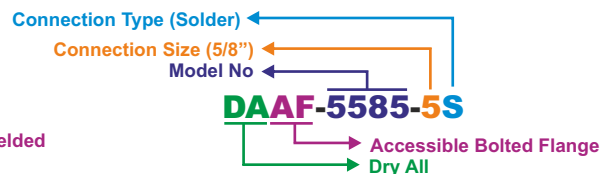
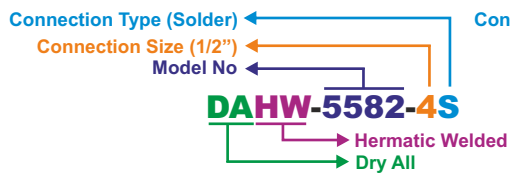

IMAGE, DRAWINGS & MODELS AVAILABLE

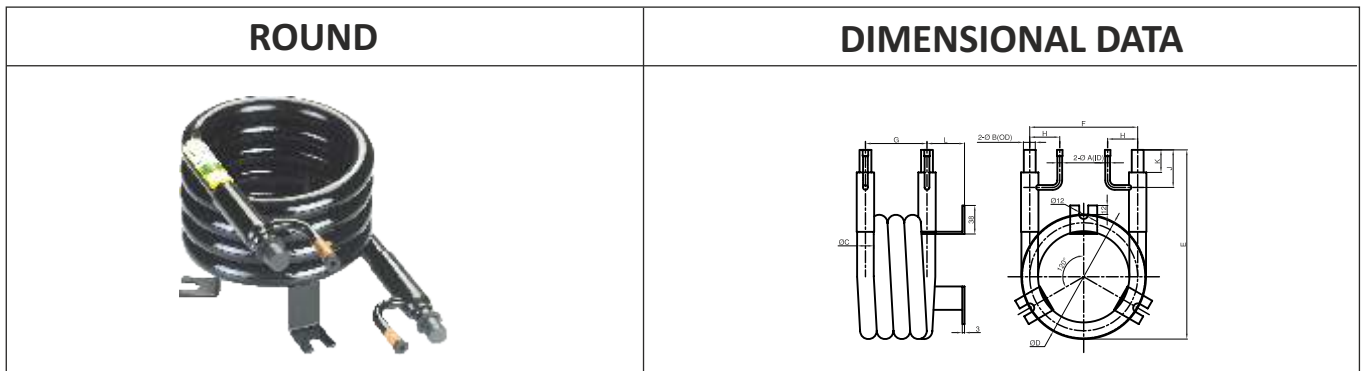

Model No.	Nom. Ton	Refrigerant Connection In/Out (I.D.)		Connection In/Out (O.D.)	Ø C"	Ø D		E		F		G		H		J		K		L	
		A	B			mm	inch	mm	inch	mm	inch	mm	inch	mm	inch	mm	inch	mm	inch	mm	inch
DA-COAX-0050GT	1/2	3/8"	5/8"	7/8"	166	6.54	252	9.92	146	5.75	59	2.32	40	1.57	50	1.97	30	1.18	50	1.97	
DA-COAX-0055GT	3/4	3/8"	5/8"	7/8"	166	6.54	252	9.92	146	5.75	82	3.23	40	1.57	50	1.97	30	1.18	50	1.97	
DA-COAX-0060GT	1	3/8"	5/8"	7/8"	166	6.54	252	9.92	146	5.75	106	4.17	40	1.57	50	1.97	30	1.18	50	1.97	
DA-COAX-0075GT	1-1/2	3/8"	18mm	1"	248	9.76	340	13.39	230	9.06	94	3.70	50	1.57	50	1.97	30	1.18	50	1.97	

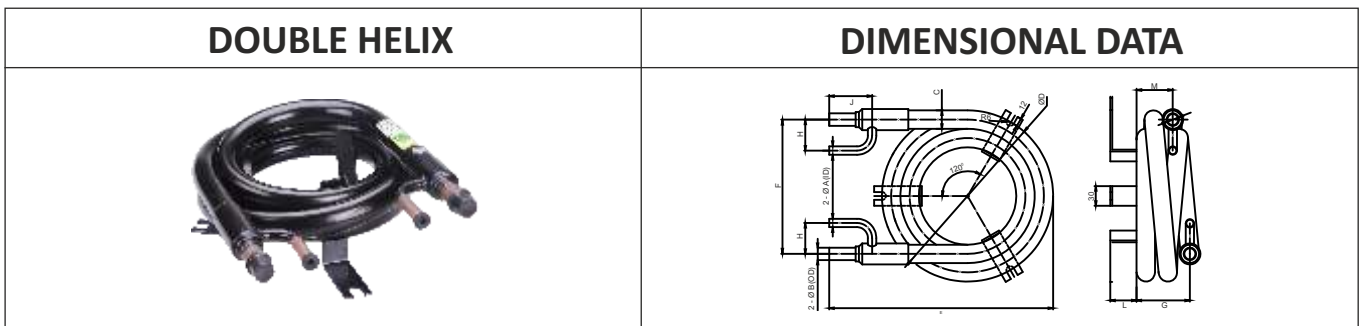

Model No.	Nom. Ton	Refrigerant Connection IN/OUT (I.D.)		C	D	E		F		G		H		J		L		M		
		A	B			mm	inch	mm	inch	mm	inch	mm	inch	mm	inch	mm	inch	mm	inch	
DA-COAX-0250GT-P	2	1/2"	3/4"	28	260	10.24	340	13.39	204	8.03	81	3.19	47	1.85	65	2.56	40	1.57	55	2.17
DA-COAX-0300GT-P	3	5/8"	7/8"	33	314	12.36	353	13.90	248	9.76	105	4.13	54	2.13	65	2.56	40	1.57	70	2.76
DA-COAX-0600GT-P	5	3/4"	1 1/8"	38	381	15.00	450	17.72	305	12.01	117	4.61	58	2.28	65	2.56	40	1.57	98	3.86



R Series High Heat Treatment Performance Brazen Plate Heat Exchanger

IMAGE, DRAWINGS & MODELS AVAILABLE

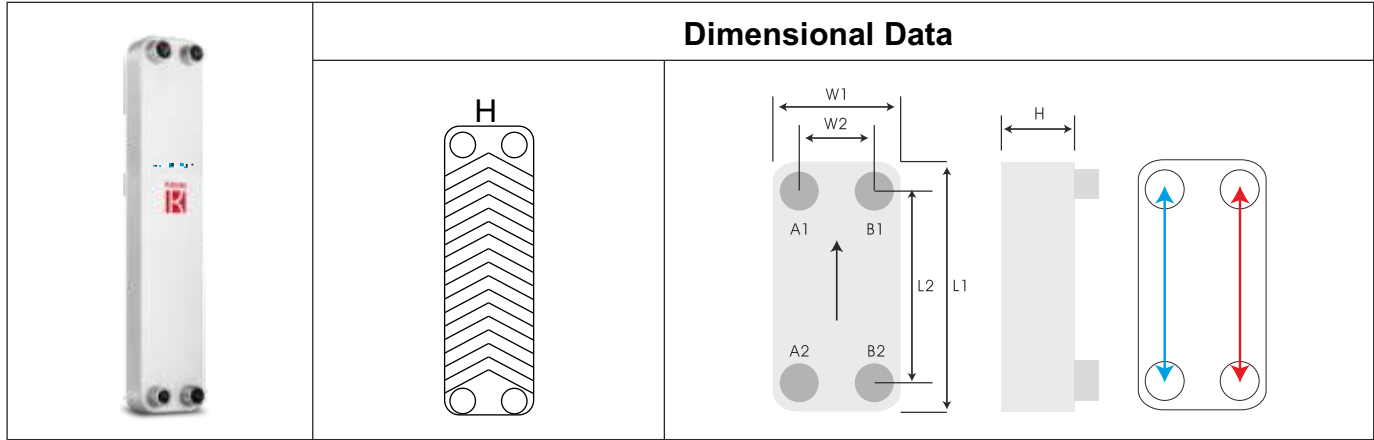

Model no	L1 (mm)	L2 (mm)	W1 (mm)	W2 (mm)	H Thickness (mm)	Connections
DA-R050-20CS7P8	306	250	106	50	46	A1, A2 - 7/8" S B1, B2 - PT 1" Male thread
DA-R050-30CS7P8	306	250	106	50	64	A1, A2 - 7/8" S B1, B2 - PT 1" Male thread
DA-R050-44CS7P8	306	250	106	50	89.2	A1, A2 - 7/8" S B1, B2 - PT 1" Male thread
DA-R095-H40B-S9	522	466	106	50	84	A1, A2 - 1-1/8" S B1, B2 - PT 1" Male thread

Model no	Capacity in TR*	No of plate (N)	Heat Transfer Area/plate (m2)	Total Heat Transfer Area (m2)	Volume/channel (Liter)	Total Volume (Litre)
DA-R050-20CS7P8	2	20	0.0255	(N-2)*0.0255	0.038	(N-1)*0.038
DA-R050-30CS7P8	3	30	0.0255	(N-2)*0.0255	0.038	(N-1)*0.038
DA-R050-44CS7P8	5	44	0.0255	(N-2)*0.0255	0.038	(N-1)*0.038
DA-R095-H40B-S9	7.5	40	0.0475	(N-2)*0.0475	0.076	(N-1)*0.076

Technical specifications:

Model/ Series: R050

Max. working pressure (bar): 30

Min. test pressure (bar): 43

Max. Working Temperature 200°C

Rating conditions: ARI-450 for Condenser side application

Rating conditions: ARI-480 for Evaporator side application

Plate material:SS316

Connection material: SS304

*Capacity are When used as Evaporator

Titanium Heat Exchanger for Swimming Pool Heat Pump Application

IMAGE, DRAWINGS & MODELS AVAILABLE

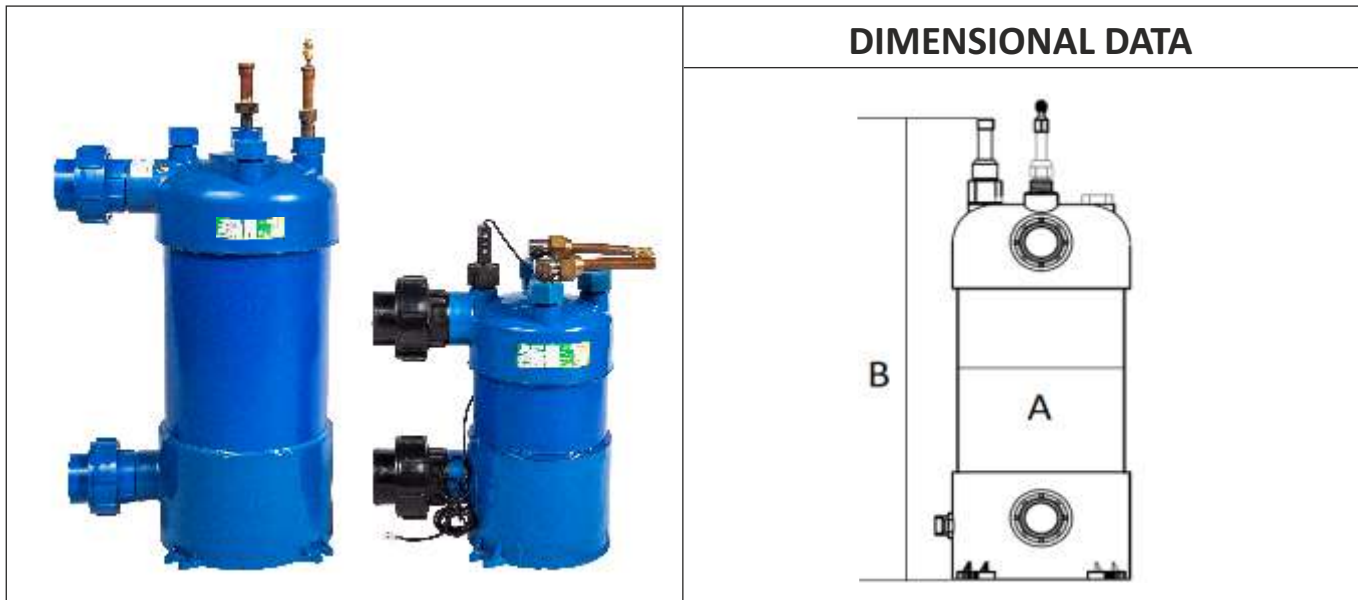

Model	Heating Capacity	Water Flow m3/h	PVC Shell Dimension A * B (mm)	Titanium Twisted Tubing Dia. *Thick* Length (mm)	Refrigeration IN/OUT mm	Water IN/OUT mm
DA-CS180PTi	18 kw	8	200*545	16*0.6*9800	φ16/φ12.7mm	φ50 PVC piston
DA-CS270PTi	27 kw	12.5	200*625	19*0.6*12500	φ19/φ12.7mm	φ50 PVC piston
DA-CS350PTi	35 kw	16.5	200*650	19*0.6*16000	φ19/φ12.7mm	φ50 PVC piston

Note:

1. Heating capacity is measured under DB/WB at 20°C/ 15°C, and inlet water temp. is 26°C, outlet water temp. is 28°C.

Working Conditions :

Parameter	Refrigerant Side (In Ti Twisted Tube)	Water Side In the Shell
Max. Pressure	45 Bar	4 Bar
Temp. Range	-50 C to 150 C	-10 C to 45 C
Refrigerant Type	R22, R134a, R404a, R407C, R410A, R600a	Sea Water , Plating Solutions , Antifreeze, Swimming Pool Water, Ground Water
Remarks	1. Please Purge Air from water system , and ensure work pressure should not exceed the max. pressure . 2. Please Keep the water clean, suggest to install filter and clean the system regularly. 3. Please drain off the water when machine stopped during the cold season to avoid freezing.	

IMAGE, DRAWINGS & MODELS AVAILABLE



Drawing



Sr. no	Model No	Capacity HP	A mm	B mm	C inch
1	DAEX - 50TT	0.5	292	1/2"	1/4"
2	DAEX - 75TT	0.75	298	5/8"	3/8"
3	DAEX - 100TT	1	350	5/8"	3/8"
4	DAEX - 150TT	1.5	368	7/8"	3/8"
5	DAEX - 200TT	2	381	1 - 1/8"	3/8"
6	DAEX - 300TT	3	381	1 - 1/8"	1/2"
7	DAEX - 500TT	5	362	1 - 3/8"	5/8"

Material Specifications:

Outer Tube: Copper

Inner Tube: Copper

Refrigerant Connections: Copper

Shell and Tube Heat Exchanger C - Series

IMAGE, DRAWINGS & MODELS AVAILABLE

Dry All
Full Range of HVAC&R Line Products

ONDA



Drawing

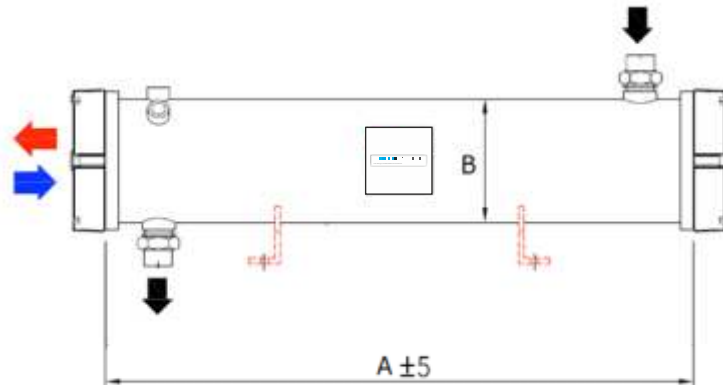

Sr. No	Capacity (TR)	No.of Passes	Length mm	Dia. Shell mm
1	2.3	4	1000	140
2	4.8	4	1000	
3	6.25	8	1000	
4	7.5	4	1000	
5	9.75	4	1000	
6	12	4	1000	168
7	14.25	4	1000	
8	16.5	4	1000	
9	33.8	2	2000	194

Note:

1. In standard conditions, Dry All-ONDA have "C" Series shell & tube condensers have a heat capacity from 2 TR to 34 TR.
2. Customized versions are available as per customer specification.
3. The higher capacity up to 2 MW is available against order.

IMAGE, DRAWINGS & MODELS AVAILABLE

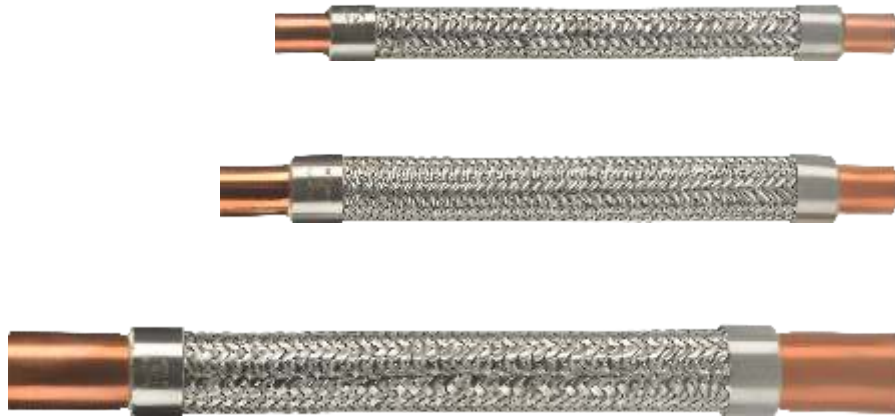

Drawing

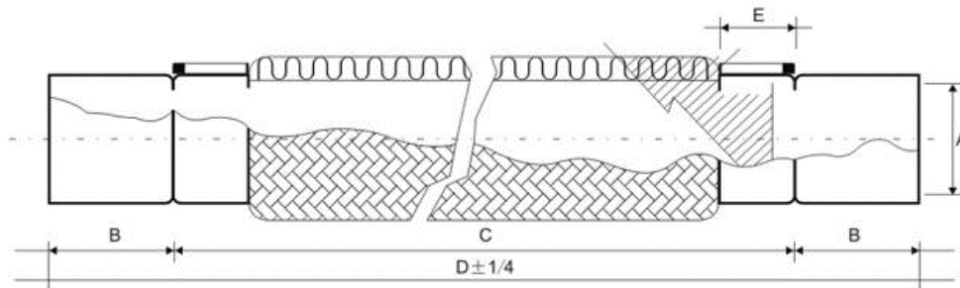

Model no	OD of copper tubing	Dimension						
		A mm	B mm	C mm	D mm	E mm	MWP	Burst Pressure
		ID	(±3)	(±3)	(±6)	(±1.5)	psig	psig
DAVA - 02S	1/4"	6.7	20	162	202	13	650	3250
DAVA - 03S	3/8"	9.6	20	177	217	13	650	3250
DAVA - 04S	1/2"	12.8	20	189	229	13	650	3250
DAVA - 05S	5/8"	16.2	22	207	251	17	650	3250
DAVA - 06S	3/4"	19.2	28	212	268	17	650	3250
DAVA - 07S	7/8"	22.3	30	245	305	18	650	3250
DAVA - 09S	1 - 1/8"	28.8	38	255	331	20	600	3000
DAVA - 11S	1 - 3/8"	35.3	40	315	395	22	550	2750
DAVA - 13S	1 - 5/8"	41.7	50	329	429	23	510	2550
DAVA - 17S	2 - 1/8"	54.5	60	404	524	23	400	2000
DAVA - 21S	2 - 5/8"	67	76	466	618	25	350	1750
DAVA 25S	3 - 1/8"	79.6	85	514	684	25	320	1600

IMAGE, DRAWINGS & MODELS AVAILABLE

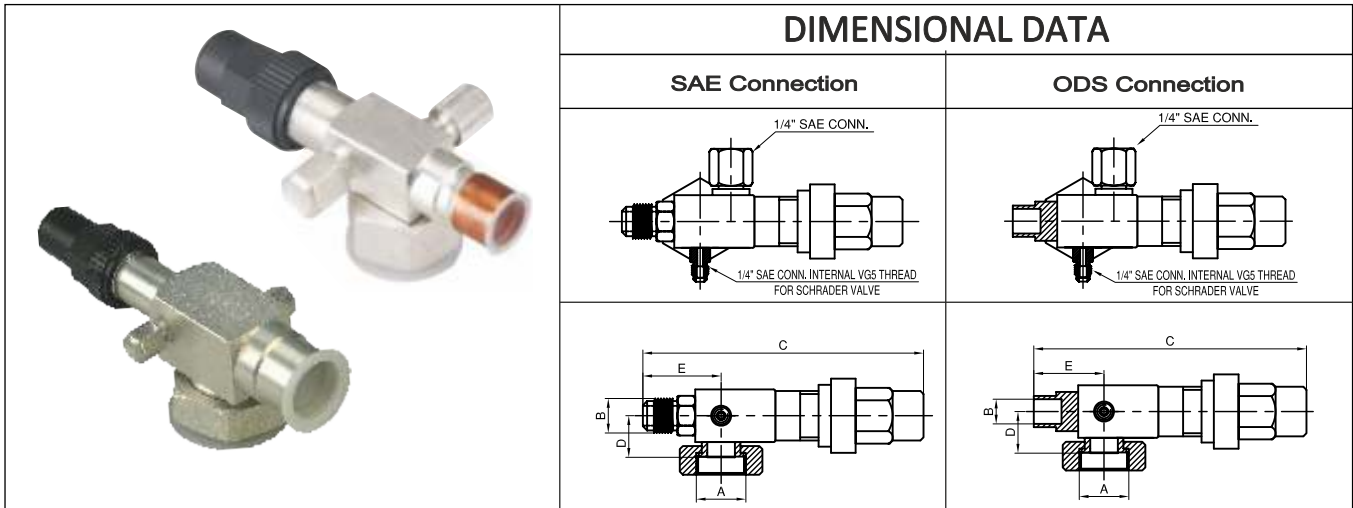

Sr. No.	Model No.	ORFS Thread	Connection size	C		D		E	
		A	B	mm	inch	mm	inch	mm	inch
1	DA 100-14-3F	1"-14 UNS	3/8" SAE	105	4.06	19	0.75	32	1.22
2	DA 100-14-3S		3/8" ODF	96	3.82	19	0.75	25	0.98
3	DAC 100-14-3S		3/8" ODF(COPPER)	110	4.53	19	0.75	37	1.45
4	DA 100-14-4F		1/2" SAE	106.5	4.11	19	0.75	32	1.30
5	DA 100-14-4S		1/2" ODF	102	4.02	19	0.75	30	1.18
6	DAC 100-14-4S		1/2" ODF(COPPER)	112	4.57	19	0.75	38	1.18
7	DA 100-14-5F		5/8" SAE	114	4.49	19	0.79	40.0	1.48
8	DA 100-14-5S		5/8" ODF	101	3.98	19	0.75	29	1.14
9	DAC 100-14-5S		5/8" ODF(COPPER)	113	4.57	19	0.75	39	1.54
10	DA 100-14-7S		7/8" ODF	132	5.08	24	0.75	40	1.57
11	DA 114-12-5S	1-1/4"-12 UNF	5/8" ODF	133	5.12	26.7	1.05	40.0	1.59
12	DA 114-12-6S		3/4" ODF	132	5.12	26.7	1.05	40.0	1.59
13	DA 114-12-7S		7/8" ODF	132	5.12	26.9	1.05	40.0	1.59
14	DA 114-12-9S	1-1/8" ODF	140	5.43	26.9	1.05	47	1.85	
15	DA 134-12-6S	1-3/4"-12 UN	3/4" ODF	130	5.12	27.5	1.08	40.5	1.59
16	DA 134-12-7S		7/8" ODF	132	5.12	27.7	1.08	40.0	1.59
17	DA 134-12-9S		1-1/8" ODF	149	5.53	28.7	1.08	57.0	1.99
18	DA 134-12-11S	1-3/8" ODF	171	6.89	30.7	1.24	56	2.20	
19	DA 214-12-11S	2-1/4"-12 UN	1-3/8" ODF	200	7.28	41.5	1.63	64.5	2.93
20	DA 214-12-13S		1-5/8" ODF	205	7.76	41.5	1.63	74.5	2.93
21	DA 214-12-17S	**For more detailed description on the models kindly visit our website: www.dryall.net Email: info@gmail.com							

OEM Replacement Rotolock Valve		
OEM	OEM P/N	Dryall Model No
DANFOSS COMPRESSORS	MT(Z)032-040 & 028-1 & LT(Z)022-028 & NTZ048-068	DA144-12-5S
		DA100-14-4S
	MT(Z)018-028 (except 022 & 028 code1)	DA100-14-4S
		DA100-14-3S
	MT(Z)044-072 & LT(Z)040-044 & NTZ096-108	DA134-12-7S
		DA114-12-6S
	MFZ166, LFZ166	DA134-12-9S
		DA114-12-6S
	MFZ250, LFZ250	DA214-12-11S
		DA134-12-7S
MT(Z)080-160 & LT(Z)050-100 & NTZ136-271 (MFZ166, LFZ166)	DA134-12-9S	
	DA114-12-6S	

OEM Replacement Rotolock Valve		
OEM	OEM P/N	Dryall Model No
EMERSON COMPRESSORS	ZR - 19	DA214-12-13S
		DA134-12-9S
	KCG SERIES 554, 562, 572	DA100-14-5S
		DA114-12-7S
	ZR - 12 & ZR - 16	DA114-12-7S
		DA134-12-11S
	ZR - 90	DA134-12-9S
		DA114-12-6S
	ZR - 11	DA134-12-11S
		DA114-12-6S

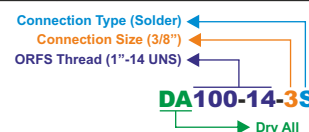

ROTOLOCK SNUB ADAPTOR (ANGLE TYPE)

IMAGES, DRAWINGS & MODELS AVAILABLE

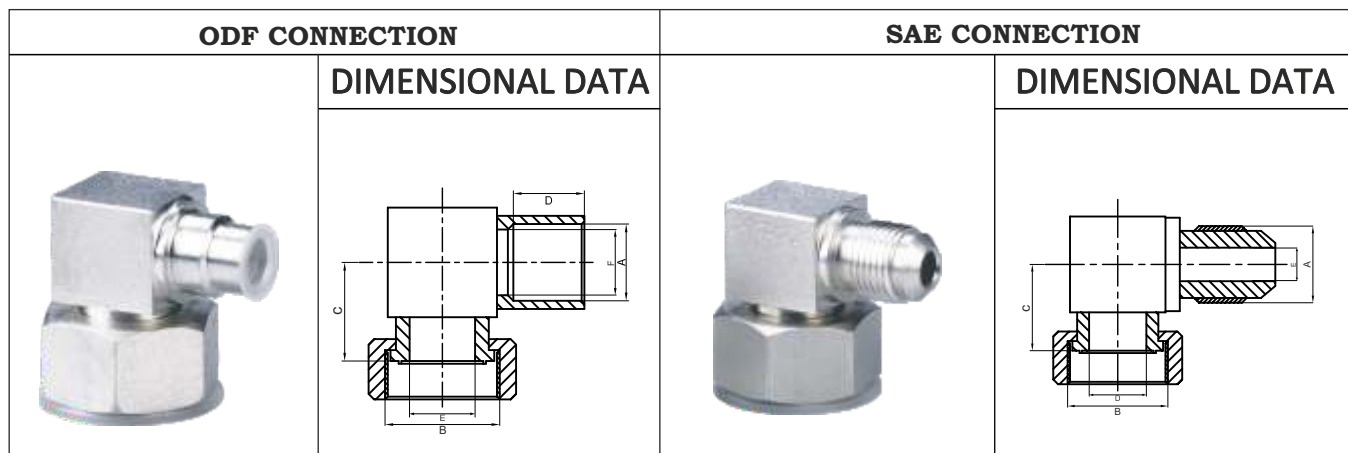

Sr. No.	Model No.	Connection Size (SAE)	ORFS Thread	C		D		E	
				mm	inch	mm	inch	mm	inch
1	DSAA34-16F-2F	1/4"	3/4"-16UNF	19	0.75	8	0.31	4.5	0.18
2	DSAA34-16F-3F	3/8"		19	0.75	8	0.31	8	0.31
3	DSAA34-16F-4F	1/2"		19	0.75	8	0.31	10	0.39
4	DSAA100-14S-3F	3/8"	1"-14 UNS	19	0.75	12	0.47	8	0.31
5	DSAA100-14S-4F	1/2"		19	0.75	12	0.47	10	0.39
6	DSAA100-14S-5F	5/8"		20	0.79	12	0.47	13	0.51
7	DSAA100-14S-6F	3/4"		20	0.79	12	0.47	16	0.63
8	DSAA114-12F-6F	3/4"	1-1/4"-12 UNF	26.7	1.05	18	0.71	16	0.63

Sr. No.	Model No.	Connection Size (ODF)	ORFS Thread	C		D		E		F		
				mm	inch	mm	inch	mm	inch	mm	inch	
1	DSAA34-16F-2S	1/4"	3/4"-16UNF	19	0.75	8	0.31	8	0.31	5	0.20	
2	DSAA34-16F-2.5S	5/16"		19	0.75	8	0.31	8	0.31	7	0.28	
3	DSAA34-16F-3S	3/8"		19	0.75	8	0.31	8	0.31	8	0.31	
4	DSAA100-14S-3S	3/8"	1"-14 UNS	19	0.75	8	0.31	12	0.47	8	0.31	
5	DSAA100-14S-4S	1/2"		19	0.75	8	0.31	12	0.47	10	0.39	
6	DSAA100-14S-5S	5/8"		20	0.79	15	0.59	13	0.51	13	0.51	
7	DSAA100-14S-6S	3/4"		19	0.75	15	0.59	13	0.51	13	0.51	
8	DSAA114-12F-5S	5/8"	1-1/4"-12 UNF	26.7	1.05	15	0.59	18	0.71	14	0.55	
9	DSAA114-12F-6S	3/4"		26.7	1.05	16	0.63	18	0.71	16	0.63	
10	DSAA114-12F-7S	7/8"		26.7	1.05	20	0.79	18	0.71	18	0.71	
11	DSAA114-12F-9S	1-1/8"		26.7	1.05	20	0.79	18	0.71	18	0.71	
12	DSAA114-12F-11S	1-3/8"		27.5	1.08	20	0.79	18	0.71	18	0.71	
13	DSAA114-12F-13S	1-5/8"		27.5	1.08	20	0.79	18	0.71	18	0.71	
14	DSAA134-12-6S	3/4"		1-3/4"-12 UN	27.5	1.08	20	0.79	19	0.75	16	0.63
15	DSAA134-12-7S	7/8"			27.5	1.08	20	0.79	19	0.75	18	0.71
16	DSAA134-12-9S	1-1/8"	27.5		1.08	20	0.79	19	0.75	18	0.71	
17	DSAA134-12-11S	1-3/8"	30.7		1.21	22	0.87	27	1.06	26	1.02	
18	DSAA134-12-13S	1-5/8"	30.7		1.21	25	0.98	27	1.06	26	1.02	

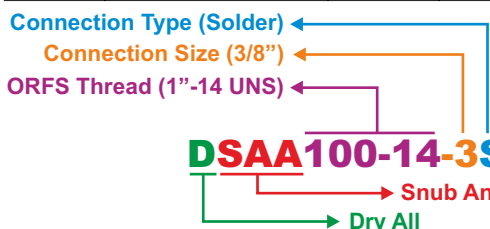

ROTOLOCK SNUB ADAPTOR (STRAIGHT TYPE)

IMAGE, DRAWING & MODELS AVAILABLE

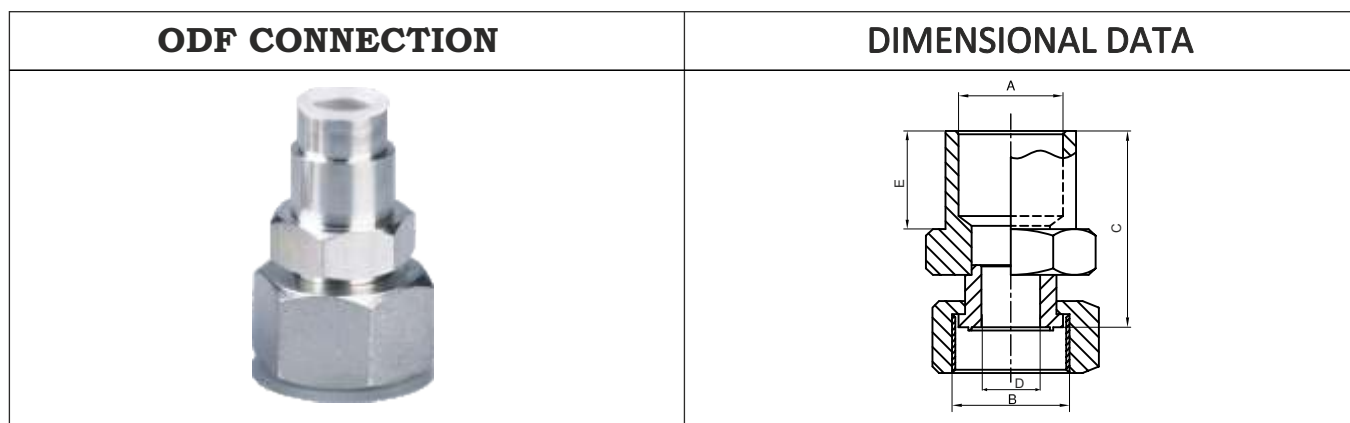

Sr. No.	Model No.	Connection Size (ODF)	ORFS Thread	C		D		E	
				mm	inch	mm	inch	mm	inch
1	DSAS34-16F-2S	1/4"	3/4"-16UNF	30	1.18	8	0.31	8	0.31
2	DSAS34-16F-4S	1/2"		30	1.18	8	0.31	10	0.39
3	DSAS100-14S-3S	3/8"	1"-14 UNS	30	1.18	12	0.47	10	0.39
4	DSAS100-14S-4S	1/2"		35	1.38	12	0.47	10	0.39
5	DSAS100-14S-5S	5/8"		35	1.38	12	0.47	16	0.63
6	DSAS100-14S-6S	3/4"		35	1.38	12	0.47	16	0.63
7	DSAS114-12F-5S	5/8"	1-1/4"-12UNF	37.7	1.48	18	0.71	16	0.63
8	DSAS114-12F-6S	3/4"		37.7	1.48	18	0.71	16	0.63
9	DSAS114-12F-7S	7/8"		43.7	1.72	18	0.71	20	0.79
10	DSAS114-12F-9S	1-1/8"		50.7	2.00	18	0.71	20	0.79
11	DSAS134-12-6S	3/4"	1-3/4"-12UN	50.7	2.00	19	0.75	20	0.79
12	DSAS134-12-7S	7/8"		45.5	1.79	19	0.75	20	0.79
13	DSAS134-12-9S	1-1/8"		55.2	2.17	19	0.75	20	0.79
14	DSAS134-12-11S	1-3/8"		55.2	2.17	19	0.75	20	0.79
15	DSAS134-12-13S	1-5/8"		57.7	2.27	19	0.75	20	0.79

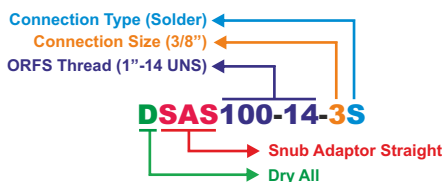

GASKET

Sr. No.	Teflon ORing	ORFS SIZE	ID		OD		THK	
			mm	Inch	mm	Inch	mm	Inch
1	DOR - A	3/4"	11.1	0.44	14.3	0.56	1.5	0.06
2	DOR - B	1"	15.7	0.62	19.1	0.75	1.5	0.06
3	DOR - C	1-1/4"	22	0.87	25.4	1.00	1.5	0.06
4	DOR - D	1-3/4"	34.7	1.37	38.1	1.50	1.5	0.06
5	DOR - E	2-1/4"	47	1.85	51	2.01	1.8	0.07

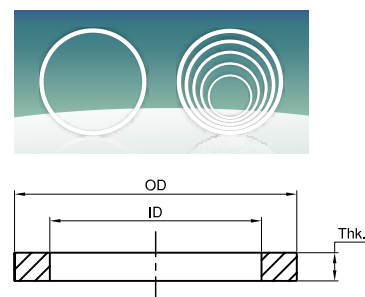

MOISTURE-LIQUID INDICATOR SIGHT GLASS

IMAGES, DRAWINGS & MODELS AVAILABLE

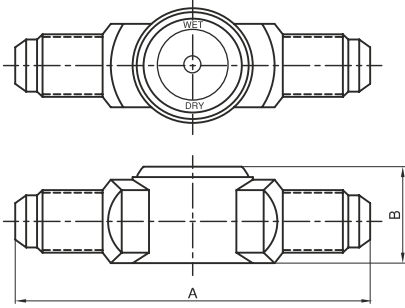
FLARE CONNECTION	DIMENSIONAL DATA
	

Sr. No.	Model No.	End Connection	A		B	
			mm	inch	mm	inch
1	DSG-02F	1/4"SAE	73	2.87	19	0.75
2	DSG-03F	3/8"SAE	70	2.76	30	1.81
3	DSG-04F	1/2"SAE	70	2.76	30	1.81
4	DSG-05F	5/8"SAE	80	3.15	30	1.81

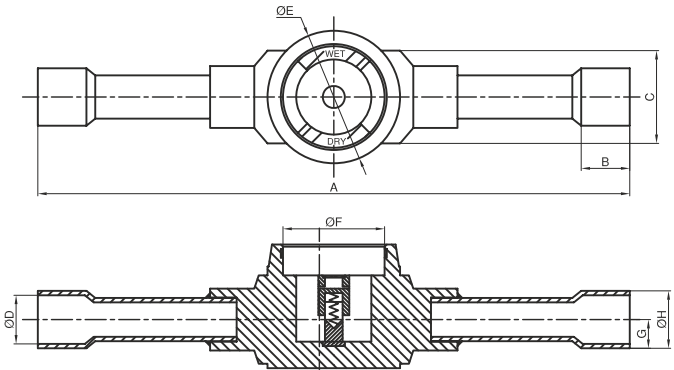
ODF CONNECTION	DIMENSIONAL DATA
	

Sr. No.	Model No.	End Connection	A		B		C		D		E		F		G		H	
			mm	inch	mm	inch	mm	inch	mm	inch	mm	inch	mm	inch	mm	inch	mm	inch
1	DSG - 02S	1/4" ODF	101	3.98	7	0.27	14	0.55	6.35	0.25	27	1.06	18.5	0.72	4	0.51	8	0.31
2	DSG - 03S	3/8" ODF	119	4.69	9	0.35	14	0.55	9.52	0.37	27	1.06	19	0.74	5.75	0.39	11.5	0.45
3	DSG - 04S	1/2" ODF	146	5.75	11.5	0.45	18	0.71	12.7	0.50	27	1.06	19	0.74	7.25	0.28	14.5	0.57
4	DSG - 05S	5/8" ODF	146	5.75	12	0.47	20.5	0.8	15.8	0.62	27	1.06	19	0.74	8.75	0.34	17.5	0.68
5	DSG - 06S	3/4" ODF	172	6.77	18	0.70	21	0.83	19.05	0.75	32	1.26	23.5	0.93	10.65	0.41	21.3	0.83
6	DSG - 07S	7/8" ODF	173	6.81	19	0.75	27	1.06	22.2	0.87	31	1.22	23.8	0.93	12.25	0.48	24.5	0.96

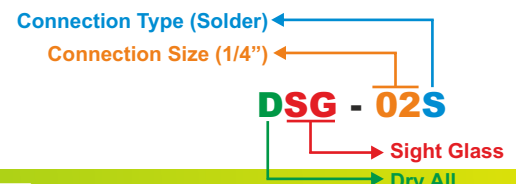

BALL VALVE

IMAGES, DRAWING & MODEL AVAILABLE

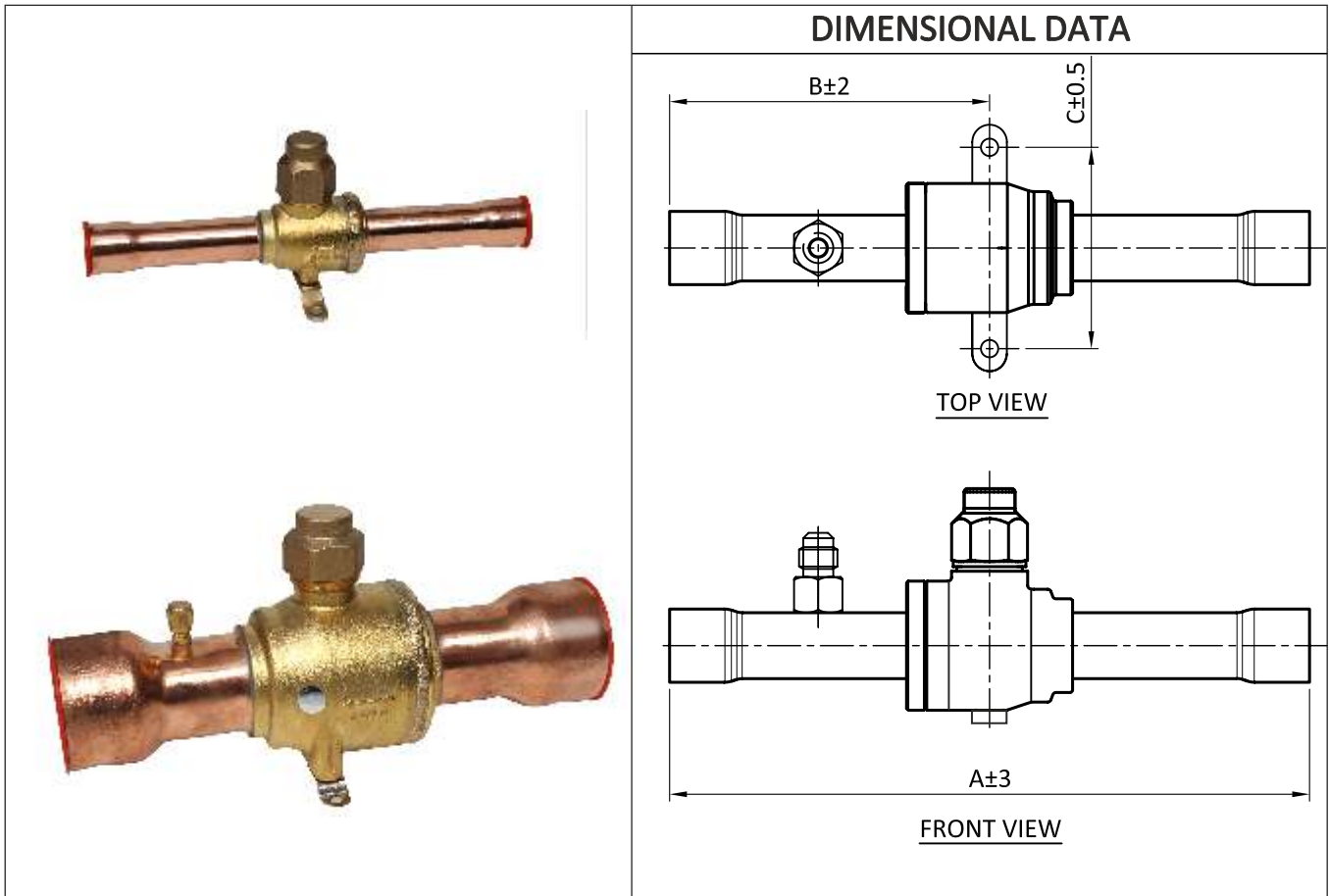

SR.NO.	Model no (With schrader valve)	Model No.	END CONNECTION	A		B		C		1/4" SAE Schrader Valve Connection
				mm	Inch	mm	Inch	mm	Inch	
1	DABVSV-02S	DABV-02S	1/4" ODF	138	5.43	53	2.09	49.5	1.95	NA
2	DABVSV-03S	DABV-03S	3/8" ODF	138	5.43	53	2.09	49.5	1.95	
3	DABVSV-04S	DABV-04S	1/2" ODF	158	6.22	73	2.87	49.5	1.95	
4	DABVSV-05S	DABV-05S	5/8" ODF	156	6.14	71	2.80	49.5	1.95	
5	DABVSV-06S	DABV-06S	3/4" ODF	166	6.54	78	3.07	70	2.76	
6	DABVSV-07S	DABV-07S	7/8" ODF	183	7.20	83	3.27	70	2.76	
7	DABVSV-09S	-	1"-1/8 ODF	207	8.15	93	3.66	69	2.72	AVAILABLE
8	DABVSV-11S	-	1"-3/8 ODF	248	9.76	114	4.49	86	3.39	
9	DABVSV-13S	-	1"-5/8 ODF	260	10.24	119	4.69	90.5	3.56	
10	DABVSV-17S	-	2"-1/8 ODF	305	12.01	151	5.94	80.5	3.17	
11	DABVSV-21S	-	2"-5/8 ODF	370	14.57	-	-	-	-	

RANGE FUSIBLE PLUG



Size
1/4" NPT
3/8" NPT
1/2" NPT

Available in 221 °C and 110 °C

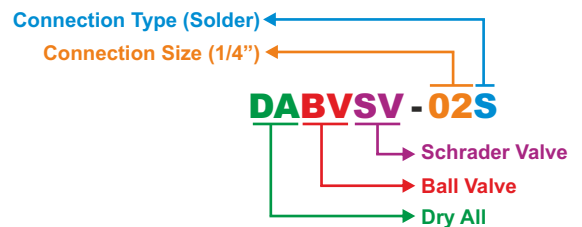

FUNDAMENTALS OF REFRIGERATION CYCLE

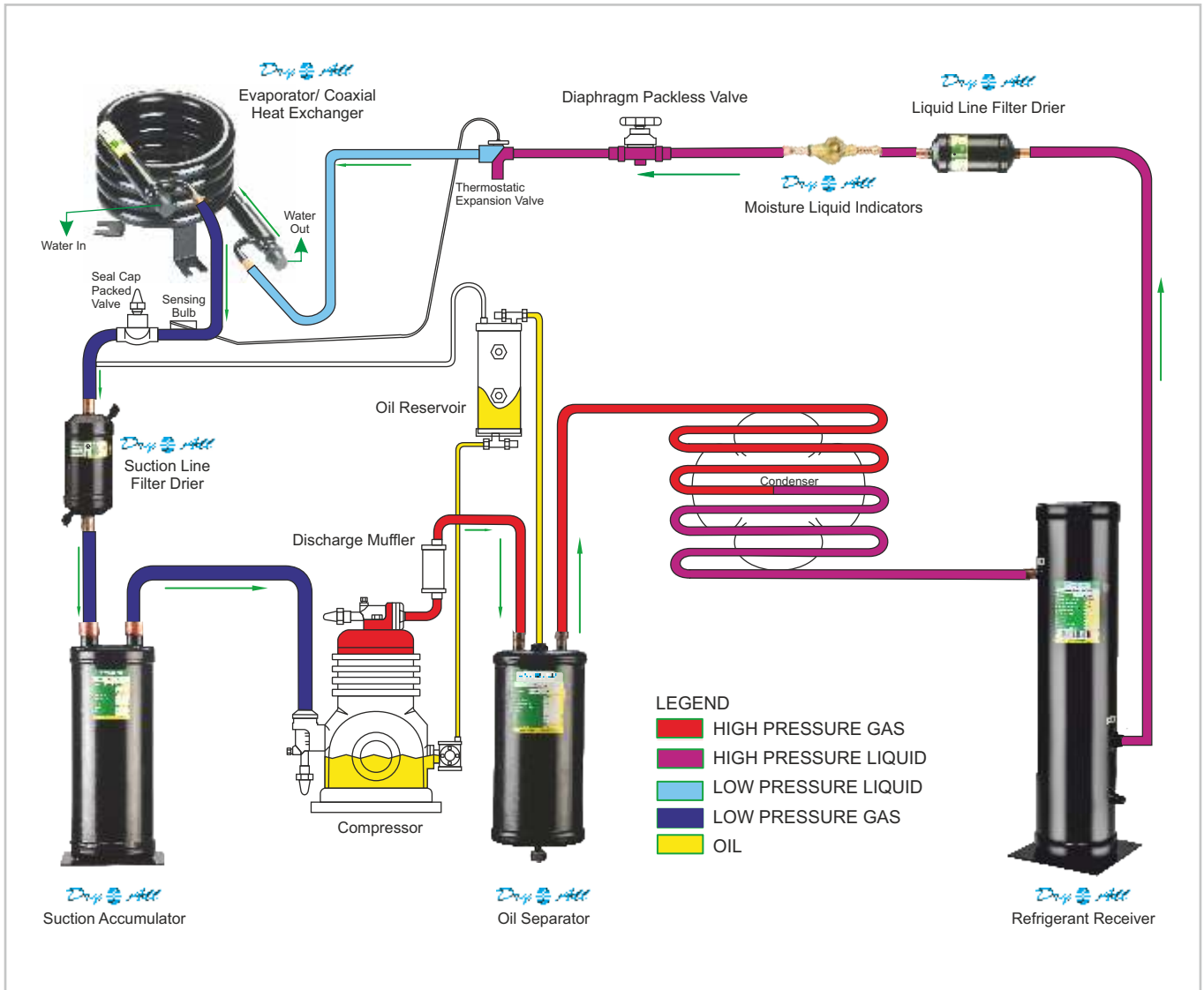

*Few models shown for representation purpose only



Hologram for Genuine Product

Manufactured by:



Full Range of HVAC&R Line Products

SAFE A&T Technology Private Limited

D-4, MIDC, Phase II, Dombivali (E),

Dist. Thane-421 201.

T : +91-(0)-251-2870680/81/82

M : +91-9619933838

Customer Care : +91 8181 994 994

E : info@dryall.net

W : www.dryall.net